



# LaserJet Pro MFP M129-M132, LaserJet Ultra MFP M133-M134 Getting Started Guide

# 2

English.....	1
Bahasa Indonesia.....	5
한국어 .....	9
ไทย .....	13
繁體中文.....	17
Tiếng Việt .....	21



## IMPORTANT:

Follow **Steps 1 - 3** on the printer hardware setup poster, then continue with **Step 4**.



[www.hp.com/support/ljm129MFP](http://www.hp.com/support/ljm129MFP)



[www.register.hp.com](http://www.register.hp.com)



## 4. Set up the control panel

At the printer control panel, check the display status before beginning software installation.

## 5. Select a connection method



### USB connection directly between the printer and the computer

Use an A-to-B type USB cable.

#### Windows

1. Do not connect the USB cable before installing the software. The installation process prompts to connect the cable at the appropriate time. If the cable is already connected, restart the printer when installation prompts to connect the cable.
2. Continue to **"6. Download and install the software."**

#### OS X

1. Connect the USB cable between the computer and the printer before installing the software.
2. Continue to **"6. Download and install the software."**



### Wired (Ethernet) network connection (optional)

Use a standard network cable.

1. Connect the network cable to the printer and to the network. Wait a few minutes for the printer to acquire a network address.
2. Continue to **"6. Download and install the software."**



### Wireless network connection (wireless models only)

#### Touchscreen control panels

1. To connect the printer to a wireless (Wi-Fi) network, on the printer control panel, touch the Wireless button.
2. Touch **Wireless Menu**, and then touch **Wireless Setup Wizard**. Select the network name from the SSID list, or enter the network name if it is not listed.
3. Use the keyboard to enter the passphrase, and then touch the **OK** button.
4. Wait while the printer establishes a network connection.
5. On the printer control panel, touch the Network button. If an IP address is listed, the network connection has been established. If not, wait a few more minutes and try again. Note the IP address for use during software installation. **Example IP address:** 192.168.0.1

#### 2-line/LED control panels

1. To connect the printer to a wireless (Wi-Fi) network, make sure that the printer, access point, and computer are turned on and that the computer is connected to the wireless network.
2. A USB cable might be required during software installation.
3. To print from a computer, continue with **"6. Download and install the software."** To print from a phone or tablet only, continue with **"7. Mobile printing (optional)."**

### Manually configure the IP address

See the printer user guide for information on how to manually configure the IP address [www.hp.com/support/ljm129MFP](http://www.hp.com/support/ljm129MFP).



G3Q57-91004

## 6. Download and install the software



### Method 1: Download HP Easy Start (Windows and OS X)

1. Go to [123.hp.com/laserjet](http://123.hp.com/laserjet), and click **Download**.
2. Follow the on-screen instructions and prompts to save the file to the computer.
3. Launch the software file from the folder where the file was saved.



### Method 2: Download from the printer support website (Windows and OS X)

1. Go to [www.hp.com/support/ijm129MFP](http://www.hp.com/support/ijm129MFP).
2. Select **Software and drivers**.
3. Download the software for your printer model and operating system.
4. Launch the software file from the folder where the file was saved.



### Method 3: Install from the printer CD (Windows only)

1. Insert the printer CD into the computer.
2. Follow the on-screen instructions to install the software. For more information see the Install Notes on the printer CD.

#### Readiris Pro for HP

Download this free software to enable extra scanning features, including Optical Character Recognition (OCR).

To download the software from the web, go to:

[www.hp.com/support/ijm129MFP](http://www.hp.com/support/ijm129MFP)

Select **Drivers**, select the appropriate operating system, and then click **Next**. Click **Application - 3rd Party**, and then click the **Download** button.

## 7. Mobile printing (optional)

### 7.1 Connect the device to the wireless network

To print from a phone or tablet, connect the device to the same wireless network as the printer.

**Apple iOS devices (AirPrint):** Open the item to print, and select the Action icon. Select **Print**, select the printer, and then select **Print**.

**Android devices (4.4 or newer):** Open the item to print, and select the **Menu** button. Select **Print**, select the printer, and select **Print**.

Some devices require downloading the HP Print Service plugin app from the Google Play store.

**Windows Phone:** Download the HP AiO Remote app from the Windows Store.

#### Learn more about mobile printing

For further information on these and other operating systems (Chrome/Google Cloud Print) go to "[www.hp.com/go/LaserJetMobilePrinting](http://www.hp.com/go/LaserJetMobilePrinting)" or scan the QR code below.



### 7.2 Wi-Fi Direct (wireless models only)

Wi-Fi Direct enables close-proximity printing from a wireless mobile device directly to an Wi-Fi Direct-enabled printer without requiring a connection to a network or the Internet.

#### Enable Wi-Fi Direct

To enable Wi-Fi Direct from the control panel, complete the following steps.

1. **2-line control panels:** On the printer control panel, press the Setup button, and then open the Network Setup menu.  
**Touchscreen control panels:** From the Home screen on the printer control panel, select the Connection Information button.
2. Open the following menus:
  - **Wi-Fi Direct**
  - **Settings** (touchscreen control panels only)
  - **On/Off**
3. Touch the **On** menu item. Touching the **Off** button disables Wi-Fi Direct printing.

For more information on wireless printing and wireless setup, go to [www.hp.com/go/wirelessprinting](http://www.hp.com/go/wirelessprinting).

#### Discover the printer

1. From the mobile device, turn on the Wi-Fi, and search for wireless networks.
2. Select the printer, which will show up as 'Direct-model-name' as shown on the printer control panel.  
**Example printer name:** "Direct-bb-HP M277 Laserjet".

## 8. Set up HP ePrint via email (optional)

Use HP ePrint via email to print documents by sending them as an email attachment to the printer's email address from any email enabled device, even from devices that are not on the same network.

To use HP ePrint via email, the printer must meet these requirements:

- The printer must be connected to a wired or wireless network and have Internet access.
- HP Web Services must be enabled on the printer, and the printer must be registered with HP Connected.

#### Enable HP Web Services

##### 2-line LCD control panel

1. Once the printer is connected to a network, enter the printer's network IP address into a web browser. Use one of the following options to find the printer IP:
  - Go to "Find printer IP address," in this getting started guide
  - Refer to the user guide
2. On the web page that appears, click the **HP Web Services** tab.
3. Review and accept the terms of use, and then click the **Enable** button.

##### Touchscreen control panel

1. From the Home screen on the printer control panel, touch the **Web Services** button.
2. Touch the **Enable Web Services** button. The printer enables Web Services, and then prints an information page. The information page contains a printer code necessary to register the HP printer at HP Connected.
3. Go to [www.hpconnected.com](http://www.hpconnected.com) to create an HP ePrint account and complete the setup process.

## 9. Set up fax (fax models only - optional)

### 9.1 Connect the printer

The printer is an analog device. HP recommends using the printer on a dedicated analog telephone line.

 **NOTE:** Some countries/regions might require an adapter for the phone cord that came with the printer.

Connect the phone cord that came with the printer to the Fax  port on the printer and to the telephone jack on the wall.

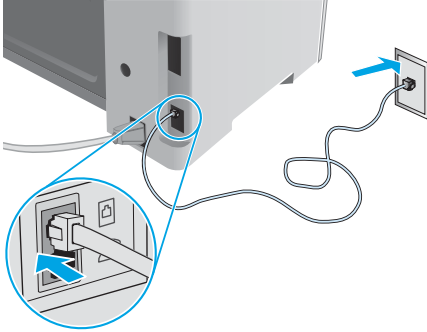

#### How do I connect an answering machine or extension phone?

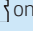
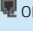
1. Remove the plug from the phone port .
2. Disconnect the answering machine phone cord from the phone jack, and then connect it to the phone port  on the printer.
3. Connect the phone cord that came with the printer to the fax port  on the printer and to the telephone jack on the wall.

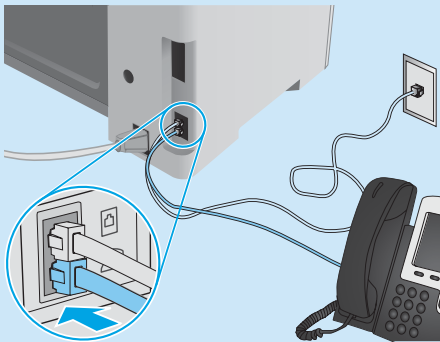

#### How do I set up HP printers in digital phone environments?

HP printers are designed specifically for use with traditional analog phone services. For a digital phone environment (such as DSL/ADSL, PBX, ISDN, or FoIP), digital-to-analog filters or converters might be necessary when setting up the printer for fax.

**Note:** Depending on the phone company, the printer might not be compatible with all digital service lines or providers, in all digital environments, or with all digital-to-analog converters. Contact the phone company to determine which setup options are best.

**Note:** When setting up ring pattern detection in a PBX phone system that has different ring patterns for internal and external calls, make sure to dial the printer fax number using an external number for recording the ring pattern.



### 9.2 Configure the printer

Configuring the fax time, date, and header settings is required to use the fax feature.



#### HP Fax Setup Wizard (Windows)

1. Click **Start**, and then click **Programs**.
2. Click **HP**, click the name of the printer, and then click **Fax Setup Wizard**.
3. Follow the on-screen instructions to configure the fax settings.

#### 2-line LCD control panel

1. On the printer control panel, press the Setup  button.
  2. Select **System Setup**, and then select **Time/Date**.
  3. Select **Time/Date**.
  4. Select the **12-hour** or **24-hour**.
  5. Use the keypad to enter the current time, and then press the **OK** button.
  6. Select the date format.
  7. Use the keypad to enter the current date, and then press the **OK** button.
  8. From the **Setup** menu, select **Fax Setup**, and then select **Fax Header**.
  9. Use the keypad to enter the fax number, and then press the **OK** button.
-  **NOTE:** The maximum number of characters for the fax number is 20.
-  **NOTE:** The maximum number of characters for the fax header is 40.

#### Touchscreen control panel

1. From the Home screen on the printer control panel, touch the Setup  button.
  2. Select **Fax Setup**, and then select **Basic Setup**.
  3. Select **Time/Date**.
  4. Select the **12-hour** or **24-hour**.
  5. Use the keypad to enter the current time, and then touch the **OK** button.
  6. Select the date format.
  7. Use the keypad to enter the current date, and then touch the **OK** button.
  8. Select **Fax Header**.
  9. Use the keypad to enter the fax number, and then touch the **OK** button.
-  **NOTE:** The maximum number of characters for the fax number is 20.
10. Use the keypad to enter your company name or header, and then touch the **OK** button.
- To enter special characters that are not on the standard keypad, touch the **@#\$** button to open a keypad that contains special characters.

 **NOTE:** The maximum number of characters for the fax header is 40.

#### Learn more!

For more information about other ways to send faxes, such as scheduling a fax to be sent later or sending faxes from a computer, see the user guide on the printer CD, or go to:  
[www.hp.com/support/ljm129MEP](http://www.hp.com/support/ljm129MEP)

## 10. Use the scan feature

Use the HP Scan software on your computer to start a scan job at the printer.

### Windows

Open HP Printer Assistant, select **Scan**, and then select **Scan a Document or Photo**.

### OS X

Click **Applications**, select **HP**, and then select **HP Easy Scan**.

## Troubleshooting

### User guide

The user guide includes printer usage and troubleshooting information. It is available on the printer CD and on the web:

1. Go to: [www.hp.com/support/ijm129MFP](http://www.hp.com/support/ijm129MFP)
2. Select the appropriate language, and then select the printer if prompted to, and then click **User Guides**.

### Check for firmware updates

1. Go to: [www.hp.com/support/ijm129MFP](http://www.hp.com/support/ijm129MFP)
2. Select a printer or category from the list, and then click **Drivers**.
3. Select the operating system, and click the **Next** button.
4. Select **Firmware**, and click the **Download** button.

### Control panel help (touchscreen models only)

Touch the Help  button on the printer control panel to access help topics.

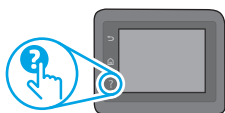

### Resolve error code messages

#### Lights Status

The Attention Light is blinking



#### Error code

Er/01



#### Action

Load the paper into the tray



### Additional support resources

For HP's all-inclusive help for the printer, go to: [www.hp.com/support/ijm129MFP](http://www.hp.com/support/ijm129MFP)

- Solve problems
- Find advanced configuration instructions
- Download software updates
- Join support forums
- Find warranty and regulatory information
- Access mobile printing resources

### Wired (Ethernet) network connection (optional)

- Verify that the printer is attached to the correct network port using a cable of the correct length.
- Verify that the lights next to the network port are lit.
- Verify that the print driver is installed on the computer.
- Test the network connection by pinging the network:

#### Windows

Click **Start** > **Run**. Type **cmd**, and press **ENTER**. Type **ping**, type a space, type the printer IP address, and then press **ENTER**. **Example IP address:** 192.168.0.1. To find the printer IP, see "Find the printer IP address."

#### OS X

Open the Network Utility, and type the IP address in the **ping** pane. Press **ENTER**. **Example IP address:** 192.168.0.1. To find the printer IP, see "Find the printer IP address."

- If the window displays round-trip times, the network is working.
- If the ping does not work, try restarting the printer and recheck all of the connection steps.

### Wireless network connection (wireless models)

- Verify that the network cable is not connected. The printer cannot connect to a wireless network when a network cable is connected.
- Verify that the printer and wireless router are turned on and have power. Also make sure the wireless switch is turned on.
- Verify that the printer is within the range of the wireless network. For most networks, the printer must be within 30 m (100 ft) of the wireless access point (wireless router).
- Verify that the print driver is installed on the computer.
- Verify that the computer and printer connect to the same wireless network.
- For Mac, verify that the wireless router supports Bonjour.
- Restart the wireless router.

### Fax troubleshooting (fn, fp, and fw models only)

#### Verify the physical connection

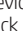
- Verify that the phone cord is connected to the fax  port on the back of the printer and to the wall jack.
- For an extension phone or other additional device, verify the phone cord is connected to the telephone  port on the back of the printer and to the device.
- If outgoing phone calls fail because no dial tone is detected or the line is busy, connect to a different phone line.
- For Fax over IP service, reduce the **Fax Speed**, and turn off **Error Correction Mode** from the **Fax Settings** menu on the printer control panel.

#### Verify the printer fax settings

- To use a voice-mail service from the phone company or service provider, make sure that the printer **Rings to Answer** setting is set to be fewer rings than the telephone answering machine.
- If multiple phone numbers are assigned to the same physical phone line and the line is shared by multiple devices, make sure that the printer is set to the correct distinctive ring setting. Use a setting in which the printer answers faxes and ignores other ring types.
- Configuring the Fax Speed setting to **Medium (V.17)** or **Slow (V.29)** can also improve your ability to send a fax.





# LaserJet Pro MFP M129-M132, LaserJet Ultra MFP M133-M134 Panduan Persiapan

English.....1

Bahasa Indonesia.....5

한국어 .....9

ไทย ..... 13

繁體中文..... 17

Tiếng Việt ..... 21



## PENTING:

Ikuti **Langkah 1 - 3**  
pada poster konfigurasi  
perangkat keras printer, lalu  
lanjutkan ke **Langkah 4**.



[www.hp.com/support/ljm129MFP](http://www.hp.com/support/ljm129MFP)



[www.register.hp.com](http://www.register.hp.com)



## 4. Mengkonfigurasi panel kontrol

Pada panel kontrol printer, periksa status layar sebelum memulai penginstalan perangkat lunak.

## 5. Memilih metode sambungan



### Sambungan USB secara langsung antara printer dan komputer

Gunakan kabel USB tipe A-ke-B.

#### Windows

1. Jangan sambungkan kabel USB sebelum menginstal perangkat lunak. Proses penginstalan meminta agar kabel disambungkan pada waktu yang tepat. Jika kabel telah tersambung, hidupkan ulang printer saat penginstalan meminta agar kabel disambungkan.
2. Lanjutkan ke "**6. Download dan instal perangkat lunak**".

#### OS X

1. Sambungkan kabel USB antara komputer dan printer sebelum menginstal perangkat lunak.
2. Lanjutkan ke "**6. Download dan instal perangkat lunak**".



### Sambungan jaringan berkabel (Ethernet) (opsional)

Gunakan kabel jaringan standar.

1. Sambungkan kabel jaringan ke printer dan jaringan. Tunggu beberapa menit agar printer mendapatkan alamat jaringan.
2. Lanjutkan ke "**6. Download dan instal perangkat lunak**".



### Sambungan jaringan nirkabel (hanya model nirkabel)

#### Panel kontrol layar sentuh

1. Untuk menyambungkan printer ke jaringan nirkabel (Wi-Fi), pada panel kontrol printer, sentuh tombol Wireless (Nirkabel).
2. Sentuh **Wireless Menu** (Menu Nirkabel), lalu sentuh **Wireless Setup Wizard** (Panduan Konfigurasi Nirkabel). Pilih nama jaringan dari daftar SSID, atau masukkan nama jaringan jika tidak tercantum dalam daftar.
3. Gunakan keyboard untuk memasukkan frasa akses, lalu sentuh tombol **OK**.
4. Tunggu sementara printer menetapkan sambungan jaringan.
5. Pada panel kontrol printer, sentuh tombol Network (Jaringan). Jika alamat IP tercantum dalam daftar, berarti sambungan jaringan telah ditetapkan. Jika tidak, tunggu beberapa menit, lalu coba lagi. Catat alamat IP untuk digunakan saat penginstalan perangkat lunak berlangsung. **Contoh alamat IP:** 192.168.0.1

#### Panel kontrol LED/2 baris

1. Untuk menyambungkan printer ke jaringan nirkabel (Wi-Fi), pastikan printer, jalur akses, dan komputer telah dihidupkan dan komputer tersambung ke jaringan nirkabel.
2. Kabel USB mungkin diperlukan selama penginstalan perangkat lunak.
3. Untuk mencetak dari komputer, lanjutkan ke "**6. Download dan instal perangkat lunak**". Untuk mencetak hanya dari telepon atau tablet, lanjutkan ke "**7. Pencetakan seluler (opsional)**".

## 1 Mengkonfigurasi alamat IP secara manual

Lihat panduan pengguna printer untuk mendapatkan informasi tentang cara mengkonfigurasi alamat IP secara manual [www.hp.com/support/ljm129MFP](http://www.hp.com/support/ljm129MFP).

## 6. Download dan instal perangkat lunak



### Metode 1: Download HP Easy Start (Windows dan OS X)

1. Kunjungi [123.hp.com/laserjet](http://123.hp.com/laserjet), lalu klik **Download**.
2. Ikuti petunjuk pada layar dan perintah untuk menyimpan file di komputer.
3. Jalankan file perangkat lunak dari folder yang menyimpan file.



### Metode 2: Download dari situs web dukungan printer (Windows dan OS X)

1. Kunjungi [www.hp.com/support/ljM129MEFP](http://www.hp.com/support/ljM129MEFP).
2. Pilih **Software** (Perangkat Lunak) dan **drivers** (driver).
3. Download perangkat lunak untuk model printer dan sistem operasi Anda.
4. Jalankan file perangkat lunak dari folder yang menyimpan file.



### Metode 3: Instal dari CD printer (hanya Windows)

1. Masukkan CD printer ke komputer.
2. Ikuti petunjuk pada layar untuk menginstal perangkat lunak. Untuk informasi lebih lanjut, lihat Catatan Penginstalan di CD printer.

#### Readiris Pro untuk HP

Download perangkat lunak gratis ini untuk mengaktifkan fitur pindai ekstra, termasuk OCR (Optical Character Recognition atau Pengenalan Karakter Optik).

Untuk men-download perangkat lunak dari web, kunjungi: [www.hp.com/support/ljM129MEFP](http://www.hp.com/support/ljM129MEFP)

Pilih **Drivers** (Driver), pilih sistem operasi yang tepat, lalu klik **Next** (Berikutnya). Klik **Application - 3rd Party** (Aplikasi Pihak Ketiga), lalu klik tombol **Download**.

## 7. Pencetakan seluler (opsional)

### 7.1 Menyambungkan perangkat ke jaringan nirkabel

Untuk mencetak dari telepon atau tablet, sambungkan perangkat ke jaringan nirkabel yang sama dengan printer.

**Perangkat Apple iOS (AirPrint):** Buka item yang akan dicetak, lalu pilih ikon Action (Tindakan). Pilih **Print** (Cetak), pilih printer, lalu pilih **Print** (Cetak).

**Perangkat Android (4.4 atau versi lebih baru):** Buka item yang akan dicetak, lalu pilih tombol **Menu**. Pilih **Print** (Cetak), pilih printer, lalu pilih **Print** (Cetak).

Perangkat tertentu mengharuskan Anda men-download aplikasi plugin Layanan HP Print dari Google Play Store.

**Windows Phone:** Download aplikasi HP AiO Remote dari Windows Store.

#### Selengkapnya tentang pencetakan seluler

Untuk informasi lebih lanjut tentang hal ini dan sistem operasi lainnya (Chrome/Google Cloud Print) kunjungi "[www.hp.com/go/LaserJetMobilePrinting](http://www.hp.com/go/LaserJetMobilePrinting)" atau pindai kode QR di bawah ini.



### 7.2 Wi-Fi Direct (hanya model nirkabel)

Wi-Fi Direct akan mengaktifkan pencetakan jarak dekat dari perangkat bergerak nirkabel secara langsung ke printer yang mengaktifkan Wi-Fi Direct tanpa memerlukan sambungan ke jaringan atau Internet.

#### Mengaktifkan Wi-Fi Direct

Untuk mengaktifkan Wi-Fi Direct dari panel kontrol, selesaikan langkah berikut.

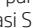
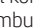
1. **Panel kontrol 2 baris:** Pada panel kontrol printer, tekan tombol  **Setup** (Konfigurasi), lalu buka menu **Network Setup** (Konfigurasi Jaringan).  
**Panel kontrol layar sentuh:** Dari layar Beranda pada panel kontrol printer, pilih tombol  /  **Connection Information** (Informasi Sambungan).
2. Buka menu berikut:
  - **Wi-Fi Direct**
  - **Pengaturan** (hanya panel kontrol layar sentuh)
  - **On/Off (Aktif/Tidak Aktif)**
3. Sentuh item menu **On** (Aktif). Menyentuh tombol **Off** (Tidak Aktif) akan menonaktifkan pencetakan Wi-Fi Direct.

 Untuk informasi selengkapnya tentang pencetakan nirkabel dan konfigurasi nirkabel, kunjungi [www.hp.com/go/wirelessprinting](http://www.hp.com/go/wirelessprinting).

#### Menemukan printer

1. Dari perangkat bergerak, aktifkan Wi-Fi, lalu cari jaringan nirkabel.
2. Pilih printer, yang akan muncul sebagai 'Direct-nama-model' seperti ditampilkan pada panel kontrol printer. **Contoh nama printer:** "Direct-bb-HP M277 Laserjet".

## 8. Mengkonfigurasi HP ePrint melalui email (opsional)

Gunakan HP ePrint melalui email untuk mencetak dokumen dengan mengirimnya sebagai lampiran email ke alamat email printer dari perangkat apa pun yang mendukung email, bahkan dari perangkat di jaringan yang berbeda.

Untuk menggunakan HP ePrint melalui email, printer harus memenuhi persyaratan berikut ini:

- Printer harus disambungkan ke jaringan berkabel atau nirkabel dan memiliki akses Internet.
- Layanan Web HP harus diaktifkan di printer, dan printer harus terdaftar di HP Connected.

### Mengaktifkan Layanan Web HP

#### Panel kontrol LCD 2 baris

1. Setelah printer tersambung ke jaringan, masukkan alamat IP jaringan printer ke browser web. Gunakan salah satu pilihan berikut untuk menemukan IP printer:
  - Buka "Menemukan alamat IP printer" dalam Panduan Persiapan ini
  - Lihat Panduan Pengguna
2. Pada halaman web yang ditampilkan, klik tab **HP Web Services** (Layanan Web HP).
3. Baca dan terima persyaratan penggunaan, lalu klik tombol **Enable** (Aktifkan).

#### Panel kontrol layar sentuh

1. Dari layar Beranda pada panel kontrol printer, sentuh tombol **Web Services**  (Layanan Web).
2. Sentuh tombol **Enable Web Services** (Aktifkan Layanan Web). Printer akan mengaktifkan Web Services (Layanan Web), lalu mencetak halaman informasi. Halaman informasi berisi kode printer yang diperlukan untuk mendaftarkan printer HP di HP Connected.
3. Kunjungi [www.hpconnected.com](http://www.hpconnected.com) untuk membuat akun HP ePrint dan menyelesaikan proses konfigurasi.

## 9. Konfigurasi faks (hanya model faks - opsional)

### 9.1 Menyambungkan printer

Printer ini adalah perangkat analog. HP menganjurkan penggunaan printer pada saluran telepon analog khusus.

**CATATAN:** Adapter mungkin diperlukan di beberapa negara/kawasan tertentu untuk menggunakan kabel telepon yang disertakan bersama printer.

Sambungkan kabel telepon yang disertakan bersama printer ke port Faks pada printer dan ke soket telepon di dinding.

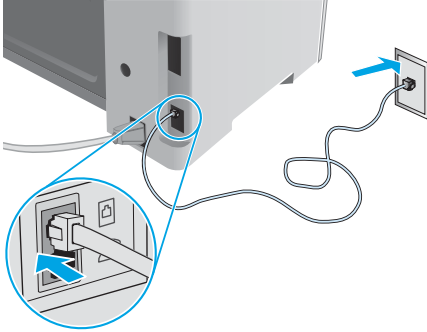

#### Bagaimana cara menyambungkan mesin penjawab atau telepon ekstensi?

1. Lepas konektor dari port telepon.
2. Lepas sambungan kabel telepon mesin penjawab dari soket telepon, lalu sambungkan ke port telepon pada printer.
3. Sambungkan kabel telepon yang disertakan bersama printer ke port faks pada printer dan ke soket telepon di dinding.

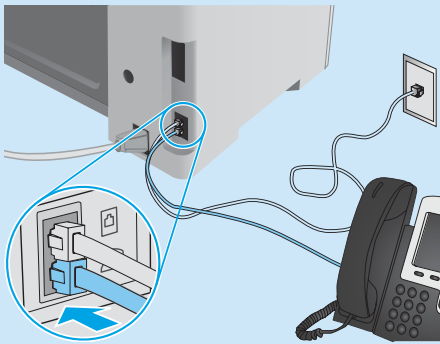

#### Bagaimana cara mengkonfigurasi printer HP dalam lingkungan telepon digital?

Printer HP dirancang khusus untuk digunakan bersama layanan telepon analog biasa. Untuk lingkungan telepon digital (misalnya, DSL/ADSL, PBX, ISDN, atau FoIP), filter atau konverter digital ke analog mungkin diperlukan bila mengkonfigurasi printer untuk faks.

**Catatan:** Tergantung pada perusahaan telepon, printer mungkin tidak kompatibel dengan semua saluran atau penyedia layanan digital, di semua lingkungan digital, atau dengan semua konverter digital ke analog. Hubungi perusahaan telepon untuk menentukan pilihan konfigurasi terbaik.

**Catatan:** Saat mengkonfigurasi deteksi pola dering dalam sistem telepon PBX yang memiliki pola dering yang berbeda untuk panggilan internal dan eksternal, pastikan menekan nomor faks printer menggunakan nomor eksternal untuk merekam pola dering.

### 9.2 Mengkonfigurasi printer

Mengkonfigurasi pengaturan waktu, tanggal, dan kepala faks diperlukan agar dapat menggunakan fitur faks.

#### Panduan Konfigurasi Faks HP (Windows)

1. Klik **Start** (Mulai), lalu klik **Programs** (Program).
2. Klik **HP**, klik nama printer, lalu klik **Fax Setup Wizard** (Panduan Konfigurasi Faks).
3. Ikuti petunjuk di layar untuk mengkonfigurasi pengaturan faks.

#### Panel kontrol LCD 2 baris

1. Pada panel kontrol printer, tekan tombol **Setup** (Konfigurasi).
2. Pilih **System Setup** (Konfigurasi Sistem), lalu pilih **Time/Date** (Waktu/Tanggal).
3. Pilih **Time/Date** (Waktu/Tanggal).
4. Pilih format **12 jam** atau **24 jam**.
5. Gunakan keypad untuk memasukkan waktu saat ini, lalu tekan tombol **OK**.
6. Pilih format tanggal.
7. Gunakan keypad untuk memasukkan tanggal saat ini, lalu tekan tombol **OK**.
8. Dari menu **Setup** (Konfigurasi), pilih **Fax Setup** (Konfigurasi Faks), lalu pilih **Fax Header** (Kepala Faks).
9. Gunakan keypad untuk memasukkan nomor faks, lalu tekan tombol **OK**.

**CATATAN:** Jumlah maksimal karakter untuk nomor faks adalah 20.

Gunakan keypad untuk memasukkan nama atau kop perusahaan Anda, lalu tekan tombol **OK**.

**CATATAN:** Jumlah maksimal karakter untuk kepala faks adalah 40.

#### Panel kontrol layar sentuh

1. Dari layar Home (Beranda) pada panel kontrol printer, sentuh tombol **Setup** (Konfigurasi).
2. Pilih **Fax Setup** (Konfigurasi Faks), lalu pilih **Basic Setup** (Konfigurasi Dasar).
3. Pilih **Time/Date** (Waktu/Tanggal).
4. Pilih format **12 jam** atau **24 jam**.
5. Gunakan keypad untuk memasukkan waktu saat ini, lalu sentuh tombol **OK**.
6. Pilih format tanggal.
7. Gunakan keypad untuk memasukkan tanggal saat ini, lalu sentuh tombol **OK**.
8. Pilih **Fax Header** (Kepala Faks).
9. Gunakan keypad untuk memasukkan nomor faks, lalu sentuh tombol **OK**.
10. Gunakan keypad untuk memasukkan nama atau kop perusahaan Anda, lalu sentuh tombol **OK**.  
Untuk memasukkan karakter khusus yang tidak ada pada keypad standar, sentuh tombol **@#\$** untuk membuka keypad yang berisi karakter khusus.

**CATATAN:** Jumlah maksimal karakter untuk kepala faks adalah 40.

#### Selengkapnya!

Untuk informasi selengkapnya tentang cara lain mengirim faks, misalnya menjadwalkan faks untuk dikirim nanti atau mengirim faks dari komputer, lihat Panduan Pengguna di CD printer atau kunjungi: [www.hp.com/support/ljM129MFP](http://www.hp.com/support/ljM129MFP)

## 10. Menggunakan fitur pindai

Gunakan perangkat lunak HP Scan di komputer untuk memulai tugas pindai pada printer.

### Windows

Buka HP Printer Assistant, pilih **Scan** (Pindai), lalu pilih **Scan a Document or Photo** (Pindai Dokumen atau Foto).

### OS X

Klik **Application** (Aplikasi), pilih **HP**, lalu pilih **HP Easy Scan**.

## Mengatasi masalah

### Panduan pengguna

Panduan pengguna berisi informasi tentang penggunaan dan cara mengatasi masalah printer. Panduan pengguna tersedia pada CD printer dan web:

1. Kunjungi: [www.hp.com/support/ijm129MEP](http://www.hp.com/support/ijm129MEP)
2. Pilih bahasa yang sesuai, pilih printer jika diminta, lalu klik **User Guides** (Panduan Pengguna).

### Memeriksa pembaruan firmware

1. Kunjungi: [www.hp.com/support/ijm129MEP](http://www.hp.com/support/ijm129MEP)
2. Pilih printer atau kategori dari daftar, lalu klik **Drivers** (Driver).
3. Pilih sistem operasi, lalu klik tombol **Next** (Berikutnya).
4. Pilih **Firmware**, lalu klik tombol **Download**.

### Bantuan panel kontrol (hanya model layar sentuh)

Sentuh tombol  **Help** (Bantuan) pada panel kontrol printer untuk mengakses topik bantuan.

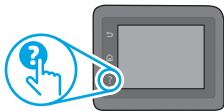

### Menyelesaikan pesan kode kesalahan

#### Status Lampu

Lampu Perhatian berkedip



#### Kode kesalahan

Er/01



#### Tindakan

Masukkan kertas ke dalam baki

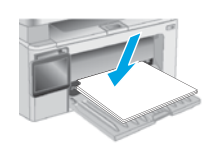

### Sumber dukungan tambahan

Untuk bantuan lengkap dari HP terkait printer, kunjungi: [www.hp.com/support/ijm129MEP](http://www.hp.com/support/ijm129MEP)

- Mengatasi masalah
- Menemukan petunjuk konfigurasi tingkat lanjut
- Men-download pembaruan perangkat lunak
- Bergabung dengan forum dukungan
- Mencari informasi jaminan dan peraturan
- Mengakses sumber pencetakan seluler

### Sambungan jaringan berkabel (Ethernet) (opsional)

- Pastikan printer telah tersambung ke port jaringan yang benar menggunakan kabel dengan panjang yang benar.
- Pastikan lampu di sebelah port jaringan telah menyala.
- Pastikan driver cetak telah terinstal di komputer.
- Uji sambungan jaringan dengan melakukan ping jaringan:

#### Windows

Klik **Start** (Mulai) > **Run** (Jalankan). Ketik **cmd**, lalu tekan **ENTER**. Ketik **ping**, ketik spasi, ketik alamat IP printer, lalu tekan **ENTER**. **Contoh alamat IP:** 192.168.0.1. Untuk menemukan IP printer, lihat "Menemukan alamat IP printer".

#### OS X

Buka Network Utility (Utilitas Jaringan), lalu ketik alamat IP pada bidang **ping**. Tekan **ENTER**. **Contoh alamat IP:** 192.168.0.1. Untuk menemukan IP printer, lihat "Menemukan alamat IP printer".



- Jika jendela menampilkan waktu respons (round-trip time), berarti jaringan berfungsi.
- Jika ping tidak berjalan, coba hidupkan ulang printer, lalu periksa kembali semua langkah sambungan.

### Sambungan jaringan nirkabel (model nirkabel)

- Pastikan kabel jaringan tidak tersambung. Printer tidak dapat tersambung ke jaringan nirkabel jika kabel jaringan tersambung.
- Pastikan printer dan router nirkabel telah diaktifkan dan dalam keadaan hidup. Pastikan juga tombol nirkabel telah diaktifkan.
- Pastikan printer telah berada dalam jangkauan jaringan nirkabel. Untuk sebagian besar jaringan, printer harus berada dalam jarak 30 m (100 kaki) dari jalur akses nirkabel (router nirkabel).
- Pastikan driver cetak telah terinstal di komputer.
- Pastikan komputer dan printer telah tersambung ke jaringan nirkabel yang sama.
- Untuk Mac, pastikan router nirkabel mendukung Bonjour.
- Hidupkan ulang router nirkabel.

### Mengatasi masalah faks (hanya model fn, fp, dan fw)

#### Memastikan sambungan fisik

- Pastikan kabel telepon telah tersambung ke port faks  di bagian belakang printer dan ke stopkontak.
- Untuk telepon ekstensi atau perangkat tambahan lainnya, pastikan kabel telepon telah tersambung ke port telepon  di bagian belakang printer dan ke perangkat.
- Jika panggilan telepon keluar gagal karena nada panggil tidak terdeteksi atau saluran sibuk, sambungkan ke saluran telepon lainnya.
- Untuk layanan Fax over IP (Faks melalui IP), kurangi **Fax Speed** (Kecepatan Faks), lalu nonaktifkan **Error Correction Mode** (Mode Koreksi Kesalahan) dari menu **Fax Settings** (Pengaturan Faks) pada panel kontrol printer.

#### Memastikan pengaturan faks printer

- Untuk menggunakan layanan pesan suara dari perusahaan atau penyedia layanan telepon, pastikan pengaturan dering **Rings to Answer** (Dering ke Jawab) printer diatur ke lebih kecil daripada mesin penjawab telepon.
- Jika beberapa nomor telepon ditetapkan pada saluran telepon fisik yang sama dan saluran digunakan juga oleh beberapa perangkat, pastikan printer telah diatur ke pengaturan dering khusus yang benar. Gunakan pengaturan agar printer menjawab faks dan mengabaikan jenis dering lainnya.
- Mengkonfigurasi pengaturan Fax Speed (Kecepatan Faks) ke **Medium (V.17)** (Sedang (V.17)) atau **Slow (V.29)** (Lambat (V.29)) juga dapat meningkatkan kemampuan pengiriman faks.



# LaserJet Pro MFP M129-M132, LaserJet Ultra MFP M133-M134 시작 설명서

English.....1

Bahasa Indonesia.....5

한국어 .....9

ไทย ..... 13

繁體中文..... 17

Tiếng Việt ..... 21



**중요:**

프린터 하드웨어 설치  
포스터의 **1~3단계**를  
수행한 다음 **4단계**를  
진행하십시오.



[www.hp.com/support/ljm129MFP](http://www.hp.com/support/ljm129MFP)



[www.register.hp.com](http://www.register.hp.com)



## 4. 제어판 설정

소프트웨어를 설치하기 전에 프린터 제어판에서 디스플레이 상태를 점검합니다.

## 5. 연결 방식 선택

### 프린터와 컴퓨터간 직접 USB 연결

A-B형 USB 케이블을 사용합니다.

#### Windows

1. 소프트웨어를 설치하기 전에 USB 케이블을 연결하지 마십시오. 설치 과정 중에 케이블을 연결하라는 메시지가 표시됩니다. 케이블이 이미 연결된 경우, 설치 중 케이블을 연결하라는 메시지가 표시되면 프린터를 재시작합니다.
2. **"6. 소프트웨어 다운로드 및 설치"**로 진행합니다.

#### OS X

1. 소프트웨어를 설치하기 전에 USB 케이블을 컴퓨터와 프린터에 연결합니다.
2. **"6. 소프트웨어 다운로드 및 설치"**로 진행합니다.

### 유선 (이더넷) 네트워크 연결 (선택 사항)

표준 네트워크 케이블을 사용합니다.

1. 네트워크 케이블을 프린터와 네트워크에 연결합니다. 프린터에서 네트워크 주소를 받을 때까지 몇 분 대기합니다.
2. **"6. 소프트웨어 다운로드 및 설치"**로 진행합니다.

### 무선 네트워크 연결(무선 모델만 해당)

#### 터치스크린 제어판

1. 프린터를 무선(Wi-Fi) 네트워크에 연결하려면 프린터 제어판에서 무선 버튼을 누릅니다.
2. 무선 메뉴를 누른 다음 무선 설정 마법사를 누릅니다. SSID 목록에서 네트워크 이름을 선택하거나 목록에 없는 경우 네트워크 이름을 입력합니다.
3. 키보드를 사용하여 암호를 입력한 다음 **확인** 버튼을 누릅니다.
4. 프린터가 네트워크 연결을 설정하는 동안 기다립니다.
5. 프린터 제어판에서 네트워크 버튼을 누릅니다. IP 주소가 표시되면 네트워크 연결이 설정된 것입니다. 그렇지 않은 경우 몇 분 더 기다린 다음 다시 시도합니다. 소프트웨어 설치 중 사용할 IP 주소를 메모합니다. **IP 주소 예:** 192.168.0.1

#### 2줄/LED 제어판

1. 프린터를 무선(Wi-Fi) 네트워크에 연결하려면 프린터 액세스 지점 및 컴퓨터가 커져 있어야 하며 컴퓨터가 무선 네트워크에 연결되어 있어야 합니다.
2. 소프트웨어 설치 시 USB 케이블이 필요할 수 있습니다.
3. 컴퓨터에서 인쇄하려면 **"6. 소프트웨어 다운로드 및 설치"**로 진행하십시오. 휴대전화나 태블릿에서만 인쇄하려면 **"7. 모바일 인쇄 (선택 사항)"**를 진행합니다.

### IP 주소 수동으로 구성

5수동으로 IP 주소를 구성하는 방법에 대한 자세한 내용은 프린터 사용 설명서 ([www.hp.com/support/ljm129MFP](http://www.hp.com/support/ljm129MFP))를 참조하십시오.

## 6. 소프트웨어 다운로드 및 설치

### 방법 1: HP Easy Start 다운로드(Windows 및 OS X)

1. [123.hp.com/laserjet](http://123.hp.com/laserjet)으로 이동한 다음 **다운로드**를 클릭합니다.
2. 화면에 표시되는 안내와 알림에 따라 컴퓨터에 파일을 저장합니다.
3. 파일이 저장된 폴더에서 소프트웨어 파일을 실행합니다.

### 방법 2: 프린터 지원 웹사이트에서 다운로드(Windows 및 OS X)

1. [www.hp.com/support/ljm129MEP](http://www.hp.com/support/ljm129MEP)로 이동합니다.
2. **소프트웨어 및 드라이버**를 선택합니다.
3. 해당 프린터 모델 및 운영 체제용 소프트웨어를 다운로드합니다.
4. 파일이 저장된 폴더에서 소프트웨어 파일을 실행합니다.

### 방법 3: 프린터 CD에서 설치 (Windows만 해당)

1. 컴퓨터에 프린터 CD를 넣습니다.
2. 화면의 지시에 따라 소프트웨어를 설치합니다. 자세한 내용은 프린터 CD의 설치 노트 파일을 참조하십시오.

#### HP용 Readiris Pro

광학 문자 인식(OCR)을 포함하여 별도의 스캔 기능을 사용할 수 있는 이 무료 소프트웨어를 다운로드하십시오.

웹에서 소프트웨어를 다운로드하려면 다음으로 이동합니다.

[www.hp.com/support/ljm129MEP](http://www.hp.com/support/ljm129MEP)

**드라이버**를 선택하고 적절한 운영 체제를 선택한 후 **다음**을 클릭합니다.  
**응용프로그램** - 타사를 클릭한 다음, **다운로드** 버튼을 클릭합니다.

## 7. 모바일 인쇄(선택 사항)

### 7.1 무선 네트워크에 장치 연결

핸드폰 또는 태블릿에서 인쇄하려면 해당 장치를 프린터와 동일한 무선 네트워크에 연결합니다.

**Apple iOS 장치 (AirPrint):** 인쇄할 항목을 열고 작업 아이콘을 선택합니다. **인쇄**를 선택하고 프린터를 선택한 다음 **인쇄**를 선택합니다.

**Android 장치 (4.4 이상 버전):** 인쇄할 항목을 열고 **메뉴** 버튼을 선택합니다. **인쇄**를 선택하고 프린터를 선택한 다음 **인쇄**를 선택합니다.

일부 장치의 경우 Google Play 스토어에서 HP 인쇄 서비스 플러그인 앱을 다운로드해야 합니다.

**Windows Phone:** Windows 스토어에서 HP AiO Remote 앱을 다운로드합니다.

### 모바일 인쇄에 대해 자세히 알아보기

관련 운영 체제(Chrome/Google 클라우드 인쇄)에 대한 추가 정보는 “[www.hp.com/go/LaserJetMobilePrinting](http://www.hp.com/go/LaserJetMobilePrinting)”을 참조하거나 아래의 QR 코드를 스캔하십시오.





### 7.2 Wi-Fi Direct (무선 모델만 해당)

Wi-Fi Direct는 네트워크 또는 인터넷에 연결할 필요 없이 무선 모바일 장치에서 Wi-Fi Direct 지원 프린터로 근접 인쇄할 수 있도록 지원합니다.

#### Wi-Fi Direct 활성화

제어판에서 Wi-Fi Direct 기능을 활성화하려면 다음 단계를 수행하십시오.

1. **2출 제어판:** 프린터 제어판에서 설정  버튼을 누른 다음 네트워크 설정 메뉴를 엽니다.  
**터치스크린 제어판:** 프린터 제어판의 홈 화면에서 연결 정보  버튼을 선택합니다.
2. 다음 메뉴를 엽니다.
  - **Wi-Fi Direct**
  - **설정** (터치스크린 제어판만 해당)
  - **켜기/끄기**
3. **켜기** 메뉴 항목을 터치합니다. Wi-Fi Direct 인쇄를 비활성화하려면 **끄기** 버튼을 누릅니다.

 무선 인쇄 및 무선 설정에 대한 자세한 내용은 [www.hp.com/go/wirelessprinting](http://www.hp.com/go/wirelessprinting)에서 확인하십시오.

#### 프린터 찾기

1. 모바일 장치에서 Wi-Fi를 켜고 무선 네트워크를 검색합니다.
2. 프린터 제어판에서 표시되는 것과 같이 ‘Direct-모델-이름’으로 표시되는 프린터를 선택합니다. **프린터 이름 예:** “Direct-bb-HP M277 Laserjet”.

## 8. 이메일을 통한 HP ePrint 설정(선택 사항)

이메일을 통한 HP ePrint를 사용하면 장치가 동일한 네트워크 상에 없어도 이메일을 사용할 수 있는 모든 장치에서 프린터의 이메일 주소로 문서를 첨부 파일로 전송하여 인쇄할 수 있습니다.

이메일을 통한 HP ePrint를 사용하려면 프린터가 다음 요구 사항을 충족해야 합니다.

- 프린터가 유선 또는 무선 네트워크에 연결되어 있고 인터넷에 접속되어야 합니다.
- 프린터에 HP 웹 서비스가 활성화되어 있어야 하며 HP Connected에 프린터가 등록되어 있어야 합니다.

### HP 웹 서비스 활성화

#### 2출 LCD 제어판

1. 프린터가 네트워크에 연결되면 웹 브라우저에 프린터의 IP 주소를 입력합니다. 다음 옵션 중 하나를 사용하여 프린터 IP를 찾습니다.
  - 이 시작 설명서에 있는 “프린터 IP 주소 찾기”로 이동
  - 사용 설명서 참조
2. 표시되는 웹 페이지에서 **HP 웹 서비스** 탭을 클릭합니다.
3. 약관을 검토하고 동의한 다음 **활성화** 버튼을 클릭합니다.

#### 터치스크린 제어판

1. 프린터 제어판의 홈 화면에서 **웹 서비스**  버튼을 누릅니다.
2. **Web Services 활성화** 버튼을 누릅니다. 프린터에서 웹 서비스가 활성화되고 정보 페이지가 인쇄됩니다. 정보 페이지에는 HP 프린터를 HP Connected에 등록하는 데 사용되는 프린터 코드가 있습니다.
3. [www.hpconnected.com](http://www.hpconnected.com)으로 이동하여 HP ePrint 계정을 만들고 설정 과정을 완료합니다.



## 9. 팩스 설정(팩스 모델만 해당 - 선택 사항)

### 9.1 프린터 연결

이 프린터는 아날로그 장치입니다. HP는 전용 아날로그 전화선에서 이 프린터를 사용하는 것이 좋습니다.

**참고:** 일부 국가/지역에서는 프린터와 함께 제공된 전화 코드에 대한 어댑터가 필요할 수 있습니다.

프린터와 함께 제공된 전화 코드를 프린터의 팩스 포트와 벽면의 전화 잭에 연결합니다.

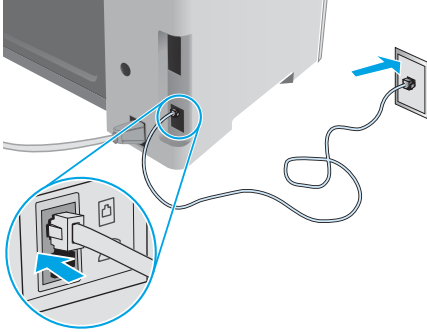

#### ① 자동 응답기나 내선 전화는 어떻게 연결하나요?

1. 전화 포트에서 플러그를 제거합니다.
2. 전화 잭에서 자동 응답기 전화 코드를 분리한 다음 프린터의 전화 포트에 연결합니다.
3. 프린터와 함께 제공된 전화 코드를 프린터의 팩스 포트와 벽면의 전화 잭에 연결합니다.

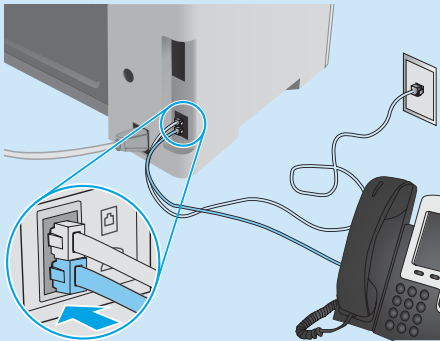

#### ① 디지털 전화기 환경에서는 HP 프린터를 어떻게 설정하나요?

HP 프린터는 기존 아날로그 전화 서비스와 함께 사용할 수 있도록 개발되었습니다. 디지털 전화기 환경(예: DSL/ADSL, PBX, ISDN, 또는 FoIP 등)의 경우 팩스용 프린터를 설치할 때 디지털-아날로그 필터 또는 변환기가 필요할 수 있습니다.

**참고:** 통신 업체에 따라 프린터가 모든 디지털 서비스 회선이나 제공 업체, 모든 디지털 환경 또는 모든 디지털-아날로그 변환기와 호환되지 않을 수 있습니다. 가장 적합한 설치 옵션을 확인하려면 통신 업체에 문의하십시오.

**참고:** 내선 및 외선 통화에 대해 다른 벨소리 종류를 가진 PBX 전화 시스템에 벨소리 종류 감지 기능을 설정할 때 외부 번호를 사용하여 프린터 팩스 번호로 전화를 걸어 벨소리 종류를 기록하십시오.

### 9.2 프린터 구성

팩스 기능을 사용하려면 팩스 시간, 날짜 및 머리글 설정을 구성해야 합니다.

#### HP 팩스 설정 마법사(Windows)

1. **시작, 프로그램**을 차례로 클릭합니다.
2. **HP**를 클릭하고 프린터 이름, **팩스 설정 마법사**를 차례로 클릭합니다.
3. 화면의 지침을 따라 팩스 설정을 구성합니다.

#### 2줄 LCD 제어판

1. 프린터 제어판에서 설정 버튼을 누릅니다.
2. **시스템 설정, 시간/날짜**를 차례로 선택합니다.
3. **시간/날짜**를 선택합니다.
4. **12시간** 또는 **24시간**형식을 선택합니다.
5. 키패드를 사용하여 현재 시간을 입력한 다음, **확인** 버튼을 누릅니다.
6. 날짜 형식을 선택합니다.
7. 키패드를 사용하여 현재 날짜를 입력한 다음, **확인** 버튼을 누릅니다.
8. **설정** 메뉴에서 **팩스 설정**을 선택한 다음 **팩스 머리글**을 선택합니다.
9. 키패드를 사용하여 팩스 번호를 입력한 다음, **확인** 버튼을 누릅니다.

**참고:** 팩스 번호로 최대 20자를 사용할 수 있습니다.

10. 키패드를 사용하여 회사 이름이나 머리글을 입력한 다음 **확인** 버튼을 누릅니다.

**참고:** 팩스 머리글로 최대 40자를 사용할 수 있습니다.

#### 터치스크린 제어판

1. 프린터 제어판의 홈 화면에서 설정 버튼을 누릅니다.
2. **팩스 설정, 기본 설정**을 차례로 선택합니다.
3. **시간/날짜**를 선택합니다.
4. **12시간** 또는 **24시간**형식을 선택합니다.
5. 키패드를 사용하여 현재 시간을 입력한 다음 **확인** 버튼을 누릅니다.
6. 날짜 형식을 선택합니다.
7. 키패드를 사용하여 현재 날짜를 입력한 다음 **확인** 버튼을 누릅니다.
8. **팩스 머리글**을 선택합니다.
9. 키패드를 사용하여 팩스 번호를 입력한 다음 **확인** 버튼을 누릅니다.

**참고:** 팩스 번호로 최대 20자를 사용할 수 있습니다.

10. 키패드를 사용하여 회사 이름이나 머리글을 입력한 다음 **확인** 버튼을 누릅니다.  
표준 키패드에 없는 특수 문자를 입력하려면 @#\$ 버튼을 눌러 특수 문자가 들어 있는 키패드를 엽니다.

**참고:** 팩스 머리글로 최대 40자를 사용할 수 있습니다.

#### ① 자세히 알아보기!

나중에 보내도록 팩스를 예약하거나 컴퓨터에서 팩스 전송 등 팩스를 보내는 다양한 방법에 대한 자세한 내용은 프린터 CD에 있는 사용 설명서를 참조하거나 다음으로 이동하십시오.

[www.hp.com/support/ijm129MFP](http://www.hp.com/support/ijm129MFP)

## 10. 스캔 기능 사용

프린터에서 스캔 작업을 시작하려면 컴퓨터의 HP Scan 소프트웨어를 사용하십시오.

### Windows

HP 프린터 길잡이에서 스캔을 선택한 다음 문서 또는 사진 스캔을 선택합니다.

### OS X

애플리케이션을 클릭한 다음 HP, HP Easy Scan을 차례로 선택합니다.

## 문제 해결

### 사용 설명서

사용 설명서에 프린터 사용법 및 문제 해결 정보가 포함되어 있습니다. 프린터 CD 및 웹에서 제공됩니다.

1. 다음으로 이동합니다. [www.hp.com/support/ijm129MFP](http://www.hp.com/support/ijm129MFP)
2. 적절한 언어를 선택한 다음, 메시지가 표시되는 경우 프린터를 선택하고 **사용 설명서**를 클릭합니다.

### 펌웨어 업데이트 확인

1. 다음으로 이동합니다. [www.hp.com/support/ijm129MFP](http://www.hp.com/support/ijm129MFP)
2. 목록에서 프린터 또는 카테고리를 선택한 다음 **드라이버**를 클릭합니다.
3. 운영 체제를 선택하고 **[다음]** 버튼을 클릭합니다.
4. **펌웨어**를 선택하고 **다운로드** 버튼을 클릭합니다.

### 제어판 도움말(터치스크린 모델만 해당)

도움말을 보려면 프린트 제어판의 도움말 ? 버튼을 누르십시오.

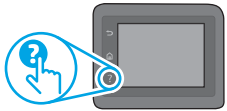

### 오류 코드 메시지 해결

#### 표시등 상태

주의 표시등 깜박임



#### 오류 코드

Er/01



#### 작업

용지함에 용지 삽입

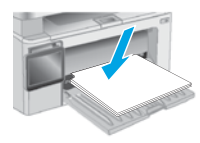

### 추가 지원 리소스

해당 프린터에 대한 HP 전체 도움말은 다음으로 이동하십시오.

[www.hp.com/support/ijm129MFP](http://www.hp.com/support/ijm129MFP)

- 문제 해결
- 고급 구성 지침 찾기
- 소프트웨어 업데이트 다운로드
- 지원 포럼 가입
- 보증 및 규정 정보 찾기
- 모바일 인쇄 리소스 액세스

### 유선 (이더넷) 네트워크 연결 (선택 사항)

- 프린터가 올바른 길이의 케이블을 사용하여 올바른 네트워크 포트에 연결되어 있는지 확인합니다.
- 네트워크 포트 옆에 있는 표시등이 켜져 있는지 확인합니다.
- 프린터 드라이버가 컴퓨터에 설치되어 있는지 확인합니다.
- 네트워크에 ping을 수행하여 네트워크 통신을 테스트합니다:

#### Windows

**시작 > 실행**을 클릭합니다. cmd를 입력하고 ENTER를 누릅니다. ping, 공백, 프린터 IP 주소를 차례로 입력한 다음 ENTER를 누릅니다. **IP 주소 예:** 192.168.0.1. 프린터 IP를 찾으려면 "프린터 IP 주소 찾기"를 참조하십시오.

#### OS X

네트워크 유틸리티를 열고 ping 창에 IP 주소를 입력합니다. ENTER를 누릅니다. **IP 주소 예:** 192.168.0.1. 프린터 IP를 찾으려면 "프린터 IP 주소 찾기"를 참조하십시오.

- 창에 왕복 시간이 표시되면 네트워크가 작동 중입니다.
- ping이 작동하지 않는 경우, 프린터를 재시작하고 모든 연결 단계를 다시 확인합니다.

### 무선 네트워크 연결(무선 모델)

- 네트워크 케이블이 연결되어 있지 않은지 확인합니다. 네트워크 케이블이 연결되어 있는 경우 프린터가 무선 네트워크에 연결할 수 없습니다.
- 프린터 및 무선 라우터가 켜져 있고 전원 에 이상이 없는지 확인합니다. 무선 스위치가 켜져 있는지도 확인합니다.
- 프린터가 무선 네트워크 범위 내에 있는지 확인합니다. 대부분의 네트워크에서는 프린터가 무선 액세스 지점(무선 라우터)의 30m(100ft) 이내에 있어야 합니다.
- 프린터 드라이버가 컴퓨터에 설치되어 있는지 확인합니다.
- 컴퓨터 및 프린터가 동일한 무선 네트워크에 연결되어 있는지 확인합니다.
- Mac의 경우 무선 라우터에서 Bonjour를 지원하는지 확인합니다.
- 무선 라우터를 재시작합니다.

### 팩스 문제 해결 (fn, fp 및 fw 모델만 해당)

#### 물리적 연결 확인

- 전화 코드가 프린터 뒷면의 팩스 포트와 벽면 전화 잭에 연결되어 있는지 확인합니다.
- 내선 전화 또는 기타 추가 장치의 경우 전화 코드가 프린터 뒷면의 전화 포트와 장치에 연결되어 있는지 확인합니다.
- 발신음이 검출되지 않거나 통화 중이어서 전화 발신에 실패하는 경우 다른 전화선에 연결합니다.
- IP 서비스를 통한 팩스의 경우, **팩스 속도**를 줄이고 프린터 제어판의 **팩스 설정** 메뉴에서 **오류 수정 모드**를 끕니다.

#### 프린터 팩스 설정 확인

- 통신 업체 또는 서비스 공급자의 음성 메일 서비스를 사용하려면 프린터의 **Rings to Answer**(전화벨 횟수) 설정이 전화 자동 응답 장치보다 적게 설정되어 있는지 확인합니다.
- 여러 전화 번호가 동일한 물리적 전화 회선에 할당되고 회선을 여러 장치에서 공유하는 경우, 프린터가 올바른 벨소리 구별 설정으로 설정되어 있는지 확인합니다. 프린터가 팩스에 응답하고 다른 발신음 유형은 무시하는 설정을 사용합니다.
- 팩스 속도 설정을 **중간 (V.17)** 또는 **느림 (V.29)**으로 구성하면 팩스 전송 성능을 향상시킬 수 있습니다.



# คู่มือเริ่มต้นใช้งาน

## LaserJet Pro MFP M129-M132, LaserJet Ultra MFP M133-M134

English.....1

Bahasa Indonesia.....5

한국어 .....9

ไทย ..... 13

繁體中文..... 17

Tiếng Việt ..... 21



### สิ่งสำคัญ:

ดำเนินการตาม **ขั้นตอนที่ 1-3**

บนโปสเตอร์การตั้งค่าฮาร์ดแวร์เครื่องพิมพ์

เสียก่อนแล้วจึงดำเนินการต่อที่ **ขั้นตอนที่ 4**



[www.hp.com/support/ljM129MFP](http://www.hp.com/support/ljM129MFP)



[www.register.hp.com](http://www.register.hp.com)



## 4. ตั้งค่าบนแผงควบคุม

ให้ตรวจสอบสถานะไฟ LED ที่แผงควบคุมเครื่องพิมพ์ ก่อนเริ่มการติดตั้งซอฟต์แวร์

## 5. เลือกวิธีการเชื่อมต่อ

### การเชื่อมต่อ USB ระหว่างเครื่องพิมพ์และคอมพิวเตอร์โดยตรง

ใช้สาย USB แบบ A-to-B

#### Windows

- ห้ามเชื่อมต่อสาย USB ก่อนที่จะติดตั้งซอฟต์แวร์ โดยขั้นตอนการติดตั้งจะพร้อมให้เชื่อมต่อสายในเวลาที่เหมาะสม หากมีการเชื่อมต่อสายอยู่แล้ว ให้รีสตาร์ทเครื่องพิมพ์เมื่อถึงขั้นตอนการติดตั้งพร้อมให้เชื่อมต่อสาย
- ดำเนินการต่อที่ **"6. ดาวน์โหลดและติดตั้งซอฟต์แวร์"**

#### OS X

- เชื่อมต่อสาย USB ระหว่างคอมพิวเตอร์และเครื่องพิมพ์ ก่อนที่จะติดตั้งซอฟต์แวร์
- ดำเนินการต่อที่ **"6. ดาวน์โหลดและติดตั้งซอฟต์แวร์"**

### การเชื่อมต่อเครือข่ายแบบไร้สาย (อีเทอร์เน็ต) (ไม่จำเป็น)

ใช้สายเครือข่ายมาตรฐาน

- เชื่อมต่อสายเครือข่ายเข้ากับเครื่องพิมพ์และเข้ากับเครือข่าย รอสองสามนาที เพื่อให้เครื่องพิมพ์รับแอดเดรสเครือข่าย
- ดำเนินการต่อที่ **"6. ดาวน์โหลดและติดตั้งซอฟต์แวร์"**

### การเชื่อมต่อเครือข่ายไร้สาย (รุ่นไร้สายเท่านั้น)

#### แผงควบคุมหน้าจอสัมผัส

- ในการเชื่อมต่อเครื่องพิมพ์กับเครือข่ายไร้สาย (Wi-Fi) บนแผงควบคุมเครื่องพิมพ์ให้แตะปุ่ม **Wi-Fi** ไร้สายบนแผงควบคุมเครื่องพิมพ์
- แตะ **เมนูไร้สาย** แล้วแตะ **วิธีการตั้งค่าแบบไร้สาย** เลือกชื่อเครือข่ายจากรายการ SSID หรือป้อนชื่อเครือข่ายหากไม่มีชื่ออยู่ในรายการ
- ใช้แป้นพิมพ์เพื่อป้อนวลีรหัสผ่าน จากนั้นแตะปุ่ม **OK**
- รอระหว่างที่เครื่องพิมพ์ทำการเชื่อมต่อกับเครือข่าย
- บนแผงควบคุมเครื่องพิมพ์ให้แตะปุ่ม เครื่องหมาย หากมี IP แอดเดรสปรากฏขึ้นแสดงว่าเชื่อมต่อกับเครือข่ายแล้ว หากไม่มีให้รอสักครู่แล้วลองอีกครั้ง จดบันทึก IP แอดเดรสเพื่อใช้ในช่วงการติดตั้งซอฟต์แวร์ ตัวอย่าง IP แอดเดรส เช่น 192.168.0.1

#### แผงควบคุม LED แบบ 2 บรรทัด

- ในการเชื่อมต่อเครื่องพิมพ์เข้ากับเครือข่ายไร้สาย (Wi-Fi) โปรดตรวจสอบให้แน่ใจว่าเครื่องพิมพ์ จุดเข้าใช้งาน และคอมพิวเตอร์เปิดอยู่ และคอมพิวเตอร์นั้นเชื่อมต่อกับเครือข่ายไร้สายแล้ว
- อาจต้องใช้สาย USB ในระหว่างที่ติดตั้งซอฟต์แวร์
- ในการพิมพ์จากคอมพิวเตอร์ให้ดำเนินการต่อที่ **"6. ดาวน์โหลดและติดตั้งซอฟต์แวร์"** ในการพิมพ์จากโทรศัพท์หรือแท็บเล็ตเท่านั้น ให้ดำเนินการต่อที่ **"7. การพิมพ์ผ่านอุปกรณ์เคลื่อนที่ (ไม่จำเป็น)"**

### การกำหนดค่า IP แอดเดรสด้วยตนเอง

โปรดดูคู่มือผู้ใช้งานเครื่องพิมพ์สำหรับข้อมูลเกี่ยวกับวิธีการกำหนดค่า IP ด้วยตนเอง [www.hp.com/support/ljM129MFP](http://www.hp.com/support/ljM129MFP)

## 6. ดาว์นโหลดและติดตั้งซอฟต์แวร์

### วิธีที่ 1: ดาว์นโหลด HP Easy Start (Windows และ OS X)

1. ไปที่ [123.hp.com/laserjet](http://123.hp.com/laserjet) และคลิก **Download** (ดาว์นโหลด)
2. ทำตามคำแนะนำบนหน้าจอและพร้อมตัวเพื่อบันทึกไฟล์ลงในคอมพิวเตอร์
3. เปิดไฟล์ซอฟต์แวร์จากโฟลเดอร์ที่บันทึกไฟล์ไว้

### วิธีที่ 2: ดาว์นโหลดจากเว็บไซต์การสนับสนุนเครื่องพิมพ์ (Windows และ OS X)

1. ไปที่ [www.hp.com/support/ljm129MFP](http://www.hp.com/support/ljm129MFP)
2. เลือก **Software and drivers** (ซอฟต์แวร์และไดรเวอร์)
3. ดาว์นโหลดซอฟต์แวร์สำหรับรุ่นเครื่องพิมพ์และระบบปฏิบัติการของคุณ
4. เปิดไฟล์ซอฟต์แวร์จากโฟลเดอร์ที่บันทึกไฟล์ไว้

### วิธีที่ 3: ติดตั้งจากแผ่นซีดีเครื่องพิมพ์ (Windows เท่านั้น)

1. ใส่แผ่นซีดีเครื่องพิมพ์เข้าไปในคอมพิวเตอร์
2. ทำตามคำแนะนำบนหน้าจอ เพื่อติดตั้งซอฟต์แวร์ โดยหากต้องการข้อมูลเพิ่มเติม โปรดดูหมายเหตุการติดตั้งในแผ่นซีดีเครื่องพิมพ์

#### Readiris Pro สำหรับ HP

ดาว์นโหลดซอฟต์แวร์ฟรีนี้ เพื่อเปิดใช้งานคุณลักษณะการสแกนเพิ่มเติม ซึ่งรวมถึงการรู้จำอักขระด้วยแสง (OCR)

ในการดาว์นโหลดซอฟต์แวร์จากเว็บ ให้ไปที่: [www.hp.com/support/ljm129MFP](http://www.hp.com/support/ljm129MFP)

เลือก **Drivers** (ไดรเวอร์) เลือกระบบปฏิบัติการที่คุณต้องการ แล้วคลิก **Next** (ถัดไป) คลิก **Application - 3rd Party** (แอปพลิเคชันของบริษัทอื่น) แล้วคลิกปุ่ม **Download** (ดาว์นโหลด)

## 7. การตั้งค่าการพิมพ์ผ่านอุปกรณ์เคลื่อนที่ (ไม่จำเป็น)

### 7.1 เชื่อมต่ออุปกรณ์กับเครือข่ายไร้สาย

ในการพิมพ์จากโทรศัพท์หรือแท็บเล็ต ให้เชื่อมต่ออุปกรณ์กับเครือข่ายไร้สายเดียวกันกับเครื่องพิมพ์

**อุปกรณ์ Apple iOS (AirPrint):** เปิดเอกสารที่จะพิมพ์ จากนั้นเลือกไอคอน Action (ดำเนินการ) เลือก **พิมพ์** แล้วเลือกเครื่องพิมพ์ จากนั้นเลือก **พิมพ์**

**อุปกรณ์ Android (4.4 หรือใหม่กว่า):** เปิดเอกสารที่จะพิมพ์ และเลือกปุ่ม **เมนู** เลือก **พิมพ์** เลือกเครื่องพิมพ์ และเลือก **พิมพ์**

อุปกรณ์บางชนิดกำหนดให้ต้องมีดาว์นโหลดแอปเสริมอย่าง HP Print Service (บริการการพิมพ์ของ HP) จาก Google Play Store

**โทรศัพท์ Windows:** ดาว์นโหลดแอป HP AiO Remote จาก Windows Store

### ศึกษาเพิ่มเติมเกี่ยวกับการพิมพ์ผ่านอุปกรณ์เคลื่อนที่

หากต้องการข้อมูลเพิ่มเติมเกี่ยวกับการพิมพ์ผ่านอุปกรณ์เคลื่อนที่ และระบบปฏิบัติการอื่นๆ (Chrome/Google Cloud Print) ให้ไปที่ [www.hp.com/go/LaserJetMobilePrinting](http://www.hp.com/go/LaserJetMobilePrinting) หรือสแกนรหัส QR ด้านล่าง



### 7.2 Wi-Fi Direct (รุ่นไร้สายเท่านั้น)

Wi-Fi Direct เปิดโอกาสให้คุณสามารถส่งพิมพ์จากอุปกรณ์เคลื่อนที่แบบไร้สายไปยังเครื่องพิมพ์ที่เปิดใช้งาน Wi-Fi Direct ซึ่งอยู่ในบริเวณใกล้เคียงกันได้โดยตรง และไม่ต้องเชื่อมต่อเครือข่ายหรืออินเทอร์เน็ต

#### เปิดใช้งาน Wi-Fi Direct

ในการเปิดใช้งาน Wi-Fi Direct จากแผงควบคุม ให้ดำเนินการตามขั้นตอนต่อไปนี้ให้เสร็จสมบูรณ์

1. **แผงควบคุม 2 บรรทัด:** บนแผงควบคุมเครื่องพิมพ์ให้กดปุ่มการตั้งค่า แล้วเปิดเมนูการตั้งค่าเครือข่าย  
**แผงควบคุมหน้าจอสัมผัส:** จากหน้าจอหลักบนแผงควบคุมเครื่องพิมพ์ ให้เลือกปุ่มข้อมูลการเชื่อมต่อ **เครือข่าย**
2. เปิดเมนูดังต่อไปนี้
  - **Wi-Fi Direct**
  - **การตั้งค่า** (แผงควบคุมหน้าจอสัมผัสเท่านั้น)
  - **เปิด/ปิด**
3. แตะรายการเมนู **เปิด** ส่วนการแตะปุ่ม **ปิด** จะปิดการใช้การพิมพ์ผ่าน Wi-Fi Direct

สำหรับข้อมูลเพิ่มเติมเกี่ยวกับการพิมพ์แบบไร้สาย รวมทั้งการตั้งค่าระบบไร้สาย ให้ไปที่ [www.hp.com/go/wirelessprinting](http://www.hp.com/go/wirelessprinting)

#### ค้นหาเครื่องพิมพ์

1. ในอุปกรณ์เคลื่อนที่ ให้เปิด Wi-Fi และค้นหาเครือข่ายไร้สาย
  2. เลือกเครื่องพิมพ์ ซึ่งจะแสดงเป็นชื่อ 'Direct-model-name' ตามที่แสดงบนแผงควบคุมเครื่องพิมพ์
- ตัวอย่างชื่อเครื่องพิมพ์ เช่น "Direct-bb-HP M277 Laserjet"

## 8. ตั้งค่า HP ePrint ผ่านอีเมล (ไม่จำเป็น)

ใช้ HP ePrint ผ่านอีเมลเพื่อพิมพ์เอกสารโดยส่งเอกสารที่จะพิมพ์เป็นไฟล์แนบอีเมลไปยังอีเมลแอดเดรสของเครื่องพิมพ์จากอุปกรณ์ใดก็ได้ที่เปิดใช้อินเทอร์เน็ต แม้ว่าอุปกรณ์นั้นจะไม่ได้เชื่อมต่อในเครือข่ายเดียวกันก็ตาม

ในการใช้ HP ePrint ผ่านอีเมล เครื่องพิมพ์จะต้องมีคุณสมบัติตามข้อกำหนดดังต่อไปนี้

- เครื่องพิมพ์ต้องเชื่อมต่อเครือข่ายแบบใช้สายหรือไร้สาย และเชื่อมต่อกับอินเทอร์เน็ตได้
- ต้องมีการเปิดใช้งาน HP Web Services บนเครื่องพิมพ์ และต้องมีการลงทะเบียนเครื่องพิมพ์กับ HP Connected

### การเปิดใช้งาน HP Web Services

แผงควบคุมหน้าจอ LCD แบบ 2 บรรทัด

1. เมื่อเครื่องพิมพ์เชื่อมต่อเครือข่ายแล้ว ให้ป้อน IP แอดเดรสเครือข่ายของเครื่องพิมพ์ในเว็บเบราว์เซอร์ แล้วใช้ตัวเลือกใดตัวเลือกหนึ่งต่อไปนี้ เพื่อค้นหา IP ของเครื่องพิมพ์
  - ไปที่หัวข้อ "ค้นหา IP แอดเดรสของเครื่องพิมพ์" ในคู่มือเริ่มต้นใช้งานนี้
  - ติดต่อผู้ให้บริการ
2. ในหน้าเว็บที่ปรากฏขึ้น ให้คลิกที่ **HP Web Services**
3. อ่านและยอมรับเงื่อนไขการใช้งาน แล้วคลิกปุ่ม **Enable** (เปิดใช้งาน)

แผงควบคุมหน้าจอสัมผัส

1. จากหน้าจอหลักบนแผงควบคุมเครื่องพิมพ์ ให้แตะปุ่ม **Web Services**
2. แตะปุ่ม **เปิดใช้งาน Web Services** เครื่องพิมพ์จะเปิดใช้งาน Web Services แล้วพิมพ์หน้าข้อมูลออกมา โดยในหน้าข้อมูลดังกล่าว จะมีรหัสเครื่องพิมพ์ที่จำเป็นต้องใช้ในการลงทะเบียนเครื่องพิมพ์ HP กับ HP Connected
3. ไปที่ [www.hpconnected.com](http://www.hpconnected.com) เพื่อสร้างบัญชี HP ePrint และดำเนินการตั้งค่าให้เสร็จสมบูรณ์

## 9. ตั้งค่าโทรสาร (รุ่นโทรสารเท่านั้น - ไม่จำเป็น)

### 9.1 เชื่อมต่อเครื่องพิมพ์

เครื่องพิมพ์นี้เป็นอุปกรณ์แบบอะนาล็อก HP จึงขอแนะนำให้ท่านใช้เครื่องพิมพ์กับสายโทรศัพท์อะนาล็อกที่แยกเฉพาะ

**หมายเหตุ:** ในบางประเทศ/พื้นที่อาจต้องใช้อะแดปเตอร์สำหรับสายโทรศัพท์ที่มากับเครื่องพิมพ์

ต่อสายโทรศัพท์ที่มาพร้อมกับเครื่องพิมพ์เข้ากับพอร์ตโทรสาร บนเครื่องพิมพ์ และต่อเข้ากับแจ็คโทรศัพท์บนผนัง

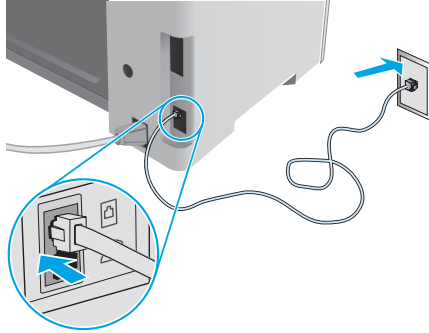

#### 1 ฉันจะเชื่อมต่อเครื่องตอบรับหรือโทรศัพท์ภายในได้อย่างไร

- ถอดที่อุดออกจากพอร์ตโทรศัพท์
- ถอดสายโทรศัพท์ของเครื่องตอบรับออกจากแจ็คโทรศัพท์ จากนั้นให้ต่อสายดังกล่าวเข้ากับพอร์ตโทรศัพท์ บนเครื่องพิมพ์
- ต่อสายโทรศัพท์ที่มาพร้อมกับเครื่องพิมพ์เข้ากับพอร์ตโทรสาร บนเครื่องพิมพ์ และต่อเข้ากับแจ็คโทรศัพท์บนผนัง

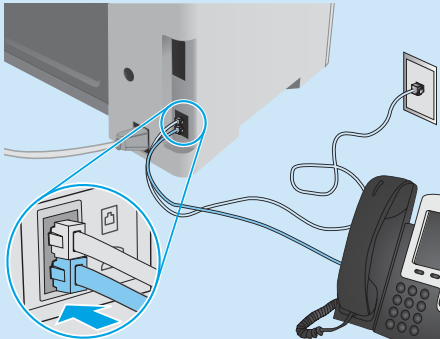

#### 1 ฉันจะตั้งค่าเครื่องพิมพ์ HP ในสภาพแวดล้อมโทรศัพท์ดิจิทัลได้อย่างไร

เครื่องพิมพ์ HP ออกแบบมาสำหรับใช้กับระบบโทรศัพท์แบบอะนาล็อกแบบดั้งเดิม โดยเฉพาะ สำหรับสภาพแวดล้อมโทรศัพท์ดิจิทัล (เช่น DSL/ADSL, PBX, ISDN หรือ FoIP) อาจจำเป็นต้องใช้ตัวกรองสัญญาณหรือตัวแปลงสัญญาณดิจิทัลเป็นอะนาล็อกเมื่อมีการตั้งค่าเครื่องพิมพ์สำหรับเครื่องโทรสาร

**หมายเหตุ:** เครื่องพิมพ์อาจทำงานร่วมกับสายบริการหรือผู้ให้บริการดิจิทัลบางรายไม่ได้ หรืออาจทำงานในสภาพแวดล้อมดิจิทัลบางอย่างไม่ได้ หรืออาจทำงานร่วมกับตัวแปลงสัญญาณดิจิทัลเป็นอะนาล็อกบางตัวไม่ได้ ทั้งนี้ขึ้นอยู่กับบริษัทโทรศัพท์นั้นๆ ให้ติดต่อบริษัทโทรศัพท์ เพื่อกำหนดตัวเลือกการตั้งค่าที่ดีที่สุด

**หมายเหตุ:** เมื่อตั้งค่าการตรวจพบรูปแบบเสียงกริ่งในระบบโทรศัพท์ PBX ที่ใช้รูปแบบเสียงเรียกที่แตกต่างกันระหว่างโทรศัพท์ภายในและภายนอกในการบันทึกรูปแบบเสียงเรียก ให้ใช้หมายเลขโทรสารภายนอกเป็นหมายเลขหมุนโทรสารของเครื่องพิมพ์

### 9.2 กำหนดค่าเครื่องพิมพ์

การกำหนดค่าเวลา วันที่ และหัวเรื่องโทรสารที่จำเป็นต่อการใช้คุณสมบัติโทรสาร

#### วิธีการติดตั้งโทรสารของ HP (Windows)

- คลิก **เริ่ม** จากนั้นคลิก **โปรแกรม**
- คลิก **HP** คลิกชื่อเครื่องพิมพ์ จากนั้นคลิก **Fax Setup Wizard** (ตัวช่วยการติดตั้งโทรสาร)
- ดำเนินการตามคำแนะนำบนหน้าจอ เพื่อกำหนดค่าโทรสาร

#### แผงควบคุมหน้าจอ LCD แบบ 2 บรรทัด

- บนแผงควบคุมเครื่องพิมพ์ ให้กดปุ่มการตั้งค่า
- เลือก **การตั้งค่าระบบ** แล้วเลือก **เวลา/วันที่**
- เลือก **เวลา/วันที่**
- เลือก **12 ชั่วโมง** หรือ **24 ชั่วโมง**
- ใช้แผงปุ่มกดเพื่อป้อนเวลาปัจจุบัน แล้วกดปุ่ม **OK**
- เลือกรูปแบบวันที่
- ใช้แผงปุ่มกดเพื่อป้อนวันที่ปัจจุบัน แล้วกดปุ่ม **OK**
- จากเมนูการตั้งค่า ให้เลือก **การตั้งค่าโทรสาร** จากนั้นเลือก **หัวเรื่องโทรสาร**
- ใช้แผงปุ่มกดเพื่อป้อนหมายเลขโทรสาร แล้วแตะปุ่ม **OK**

**หมายเหตุ:** หมายเลขโทรสารมีจำนวนตัวอักษรสูงสุดได้ 20 ตัวอักษร

- ใช้แผงปุ่มกดเพื่อป้อนชื่อบริษัทของคุณหรือหัวเรื่องโทรสาร แล้วกดปุ่ม **OK**

**หมายเหตุ:** หัวเรื่องโทรสารมีจำนวนตัวอักษรสูงสุดได้ 40 ตัวอักษร

#### แผงควบคุมหน้าจอสัมผัส

- ในหน้าจอหลักบนแผงควบคุมเครื่องพิมพ์ ให้แตะปุ่มการตั้งค่า
- เลือก **การตั้งค่าโทรสาร** แล้วเลือก **การตั้งค่าพื้นฐาน**
- เลือก **เวลา/วันที่**
- เลือก **12 ชั่วโมง** หรือ **24 ชั่วโมง**
- ใช้แผงปุ่มกดเพื่อป้อนเวลาปัจจุบัน แล้วแตะปุ่ม **OK**
- เลือกรูปแบบวันที่
- ใช้แผงปุ่มกดเพื่อป้อนวันที่ปัจจุบัน แล้วแตะปุ่ม **OK**
- เลือก **หัวเรื่องโทรสาร**
- ใช้แผงปุ่มกดเพื่อป้อนหมายเลขโทรสาร แล้วแตะปุ่ม **OK**

**หมายเหตุ:** หมายเลขโทรสารมีจำนวนตัวอักษรสูงสุดได้ 20 ตัวอักษร

- ใช้แผงปุ่มกดเพื่อป้อนชื่อบริษัทของคุณหรือหัวเรื่องโทรสาร แล้วแตะปุ่ม **OK**
- ในการป้อนตัวอักษรพิเศษที่ไม่อยู่บนแป้นพิมพ์มาตรฐาน ให้แตะปุ่ม **@#\$** เพื่อเปิดเป็นพิมพ์ที่มีตัวอักษรพิเศษ

**หมายเหตุ:** หัวเรื่องโทรสารมีจำนวนตัวอักษรสูงสุดได้ 40 ตัวอักษร

#### 1 ศึกษาเพิ่มเติม!

สำหรับข้อมูลเพิ่มเติมเกี่ยวกับวิธีส่งโทรสารแบบอื่นๆ เช่น การกำหนดเวลาส่งโทรสารในภายหลัง หรือการส่งโทรสารจากคอมพิวเตอร์ โปรดดูคู่มือผู้ใช้ในแผ่นชุดเครื่องพิมพ์หรือไม่ที่: [www.hp.com/support/li129MEFP](http://www.hp.com/support/li129MEFP)



## 10. ใช้คุณสมบัติการสแกน

ใช้ซอฟต์แวร์ HP Scan ในคอมพิวเตอร์ของคุณ เพื่อเริ่มงานสแกนที่เครื่องพิมพ์

### Windows

เปิด HP Printer Assistant และเลือก **สแกน** จากนั้นเลือก **สแกนเอกสารหรือรูปภาพ**

### OS X

คลิก **แอปพลิเคชัน** และเลือก **HP** จากนั้นเลือก **HP Easy Scan**

## การแก้ไขปัญหาเบื้องต้น

### คู่มือผู้ใช้

ในคู่มือผู้ใช้จะมีข้อมูลการใช้เครื่องพิมพ์และการแก้ไขปัญหาเบื้องต้น โดยคู่มือผู้ใช้ดังกล่าวจะมีรวมมาในแผ่นซีดีเครื่องพิมพ์ และดาวน์โหลดได้จากเว็บไซต์ต่อไปนี้

1. ไปที่: [www.hp.com/support/ijm129MFP](http://www.hp.com/support/ijm129MFP)
2. เลือกภาษาที่เหมาะสม จากนั้นเลือกเครื่องพิมพ์หากมีการพร้อมท์ให้เลือก แล้วคลิก **User Guides** (คู่มือผู้ใช้)

### การตรวจสอบอัปเดตเฟิร์มแวร์

1. ไปที่: [www.hp.com/support/ijm129MFP](http://www.hp.com/support/ijm129MFP)
2. เลือกเครื่องพิมพ์หรือหมวดหมู่จากรายการ จากนั้นคลิก **Drivers** (ไดรเวอร์)
3. เลือกระบบปฏิบัติการ และคลิกปุ่ม **Next** (ถัดไป)
4. เลือก **Firmware** (เฟิร์มแวร์) แล้วคลิกปุ่ม **Download** (ดาวน์โหลด)

### วิธีใช้บนแผงควบคุม (รุ่นหน้าจอสัมผัสเท่านั้น)

แตะปุ่มวิธีใช้ ? บนแผงควบคุมเครื่องพิมพ์ เพื่อเข้าถึงหัวข้อวิธีใช้ต่างๆ

### แก้ปัญหาของข้อความรหัสข้อผิดพลาด

#### สถานะของไฟ

ไฟสัญญาณเตือนกะพริบ



#### รหัสข้อผิดพลาด

Er/01



#### การดำเนินการ

ใส่กระดาษลงในถาด

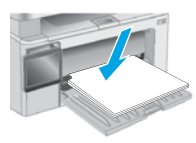

### ทรัพยากรด้านการสนับสนุนเพิ่มเติม

หากต้องการข้อมูลวิธีใช้เครื่องพิมพ์ HP แบบครบถ้วนในทีเดียว [www.hp.com/support/ijm129MFP](http://www.hp.com/support/ijm129MFP)

- แก้ปัญหา
- ค้นหาคำแนะนำด้านการกำหนดค่าขั้นสูง
- ดาวน์โหลดอัปเดตซอฟต์แวร์
- เข้าร่วมฟอรัมการสนับสนุน
- ค้นหาข้อมูลการรับประกันและข้อบังคับ
- เข้าถึงทรัพยากรการพิมพ์ผ่านอุปกรณ์เคลื่อนที่

### การเชื่อมต่อเครือข่ายแบบไร้สาย (อีเทอร์เน็ต) (ไม่จำเป็น)

- ตรวจสอบว่าเครื่องพิมพ์มีการเชื่อมต่อกับพอร์ตเครือข่ายที่ถูกต้อง โดยใช้สายที่มีความยาวเหมาะสม
- ตรวจสอบว่าไฟติดจากพอร์ตเครือข่ายเปิดสว่างอยู่
- ตรวจสอบว่าการติดตั้งไดรเวอร์การพิมพ์บนคอมพิวเตอร์แล้ว
- ทดสอบการเชื่อมต่อเครือข่ายโดยการ Ping เครื่องพิมพ์ดังนี้

#### Windows

คลิก **เริ่ม** > **เรียกใช้** พิมพ์คำว่า **cmd** และกด **ENTER** พิมพ์คำว่า **ping** เคารวรรค แล้วพิมพ์ IP แอดเดรสของเครื่องพิมพ์ จากนั้นกด **ENTER** ตัวอย่าง IP แอดเดรส เช่น 192.168.0.1 ในการค้นหา IP เครื่องพิมพ์ ให้ดูหัวข้อ "ค้นหา IP แอดเดรสของเครื่องพิมพ์"

#### OS X

เปิดหน้าต่างเครือข่าย และพิมพ์ IP แอดเดรสในบานหน้าต่าง **ping** และกด **ENTER** ตัวอย่าง IP แอดเดรส เช่น 192.168.0.1 ในการค้นหา IP เครื่องพิมพ์ ให้ดูหัวข้อ "ค้นหา IP แอดเดรสของเครื่องพิมพ์"



- หากหน้าต่างแสดงเวลาในการติดต่อ แสดงว่าเครือข่ายใช้งานได้
- หาก Ping ไม่ทำงาน ให้ลองรีเซ็ตการเชื่อมต่อเครื่องพิมพ์และตรวจสอบขั้นตอนการเชื่อมต่อใหม่ทั้งหมด

### การเชื่อมต่อเครือข่ายไร้สาย (รุ่นไร้สายเท่านั้น)

- ตรวจสอบว่าไม่ได้เชื่อมต่อสายเครือข่ายไว้ เพราะเครื่องพิมพ์จะไม่สามารถเชื่อมต่อกับเครือข่ายไร้สาย เมื่อเชื่อมต่อสายเครือข่ายอยู่
- ตรวจสอบว่าเครื่องพิมพ์และเราเตอร์ไร้สายเปิดอยู่ และมีไฟเข้า พร้อมทั้งตรวจสอบว่าเปิดสวิทช์เปิด/ปิดอุปกรณ์ไร้สายแล้ว
- ตรวจสอบว่าเครื่องพิมพ์อยู่ภายในช่วงของเครือข่ายไร้สาย สำหรับเครือข่ายส่วนใหญ่ เครื่องพิมพ์ต้องอยู่ภายในช่วง 30 ม. (100 ฟุต) ของจุดเข้าใช้งานไร้สาย (เราเตอร์ไร้สาย)
- ตรวจสอบว่ามีการติดตั้งไดรเวอร์การพิมพ์บนคอมพิวเตอร์แล้ว
- ตรวจสอบว่า คอมพิวเตอร์และเครื่องพิมพ์เชื่อมต่อกับเครือข่ายไร้สายเดียวกัน
- สำหรับ Mac ให้ตรวจสอบว่าเราเตอร์ไร้สายสนับสนุน Bonjour
- รีเซ็ตเราเตอร์ไร้สาย

### การแก้ไขปัญหาโทรสารเบื้องต้น (รุ่น fn, fp และ fw เท่านั้น)

#### ตรวจสอบการเชื่อมต่อสายบนตัวเครื่อง

- ตรวจสอบว่าสายโทรศัพท์ต่อกับกับพอร์ตโทรสาร  ที่ด้านหลังของเครื่องพิมพ์ และต่อเข้ากับแจ็คโทรศัพท์บนผนัง
- สำหรับโทรศัพท์ภายในหรืออุปกรณ์เสริมอื่นๆ ให้ตรวจสอบว่า สายโทรศัพท์ต่อเข้ากับพอร์ตโทรศัพท์  ที่ด้านหลังของเครื่องพิมพ์ และต่อเข้ากับอุปกรณ์ดังกล่าวด้วย
- หากไม่สามารถโทรออกได้ เนื่องจากตรวจไม่พบสัญญาณโทรศัพท์ หรือสายไม่ว่าง ให้ต่อกับสายโทรศัพท์เส้นอื่น
- สำหรับบริการโทรสารบน IP (Fax over IP) ให้ลด **ความเร็วโทรสาร** และปิด **โหมดแก้ไขข้อผิดพลาด** จากเมนู การติดตั้งโทรสาร บนแผงควบคุมเครื่องพิมพ์

#### ตรวจสอบการตั้งค่าโทรสารของเครื่องพิมพ์

- ในการใช้บริการข้อความเสียงจากบริษัทโทรศัพท์หรือผู้ให้บริการโทรศัพท์ ให้ตรวจสอบให้แน่ใจว่า **จำนวนการเรียกก่อนตอบรับ** ของเครื่องพิมพ์ตั้งไว้ที่ค่าน้อยกว่าจำนวนการเรียกของเครื่องตอบรับโทรศัพท์
- หากมีการกำหนดหมายเลขโทรศัพท์หลายหมายเลขให้กับสายโทรศัพท์เดียวกัน และมีการใช้สายโทรศัพท์ดังกล่าวรวมกันระหว่างอุปกรณ์หลายเครื่อง โปรดตรวจสอบให้แน่ใจว่ามีการตั้งค่าเสียงเรียกเฉพาะที่ถูกต้องให้กับเครื่องพิมพ์ โดยให้ใช้การตั้งค่าที่กำหนดให้เครื่องพิมพ์ตอบรับโทรสาร และเพิกเฉยกับประเภทเสียงเรียกอื่นๆ
- การกำหนดการตั้งค่าความเร็วโทรสารเป็น **ปานกลาง (V.17)** หรือ **ช้า (V.29)** ยังสามารถช่วยให้คุณส่งโทรสารได้มีประสิทธิภาพมากขึ้นอีกด้วย





# LaserJet Pro MFP M129-M132、 LaserJet Ultra MFP M133-M134 入門指南

English.....1

Bahasa Indonesia.....5

한국어.....9

ไทย.....13

繁體中文.....17

Tiếng Việt.....21

## ! 重要事項

依照印表機硬體設定海報  
的**步驟 1 - 3**進行後，  
再繼續執行**步驟 4**。



[www.hp.com/support/ljm129MFP](http://www.hp.com/support/ljm129MFP)



[www.register.hp.com](http://www.register.hp.com)



## 4. 設定控制面板

在印表機控制面板上，先檢查顯示器狀態，再開始進行軟體安裝。

## 5. 選擇連線方法

### 🔌 直接在印表機與電腦之間連接的 USB 連線

使用 A 對 B 型 USB 纜線。

#### Windows

- 請勿在安裝軟體之前連接 USB 纜線。安裝程序會在適當時間提示您連接纜線。如果纜線已經連接，請在安裝提示告訴您連接纜線時重新啟動印表機。
- 繼續執行「6. 下載與安裝軟體」。

#### OS X

- 先連接電腦與印表機之間的 USB 纜線，再進行軟體安裝。
- 繼續執行「6. 下載與安裝軟體」。

### 🌐 有線（乙太網路）網路連線 （選用）

使用標準網路線。

- 將網路線連接至印表機與網路。等待幾分鐘，讓印表機取得網路位址。
- 繼續執行「6. 下載與安裝軟體」。

### 📶 無線網路連線（僅限無線機型）

#### 觸控螢幕控制面板

- 若要將印表機連接至無線 (Wi-Fi) 網路，請點選印表機控制面板上的「無線」按鈕。
- 點選**無線功能表**，然後點選**無線設定精靈**。從 SSID 清單選擇網路名稱，或輸入網路名稱（如果未列出）。
- 使用鍵盤輸入複雜密碼，然後點選**確定**按鈕。
- 等待印表機建立網路連線。
- 在印表機控制面板上，點選「網路」按鈕。若列出 IP 位址，則已建立網路連線。若未列出，請等候幾分鐘後再試一次。請記下 IP 位址以便在安裝軟體時使用。**IP 位址範例**：192.168.0.1

#### 雙行/LED 控制面板

- 若要將印表機連接至無線 (Wi-Fi) 網路，請確定印表機、存取點和電腦都已開啟，而且電腦已連接至無線網路。
- 安裝軟體期間，可能需要使用 USB 纜線。
- 若要從電腦列印，請繼續執行「6. 下載與安裝軟體」。若要單純從手機或平板電腦列印，請繼續執行「7. 行動列印（選用）」。

### 🔧 手動設定 IP 位址

如需有關如何手動設定 IP 位址的詳細資訊，請參閱印表機使用指南  
[www.hp.com/support/ljm129MFP](http://www.hp.com/support/ljm129MFP)。

## 6. 下載與安裝軟體



### 方法 1：下載 HP Easy Start (Windows 和 OS X)

1. 前往 [123.hp.com/laserjet](http://123.hp.com/laserjet)，然後按一下 **Download** (下載)。
2. 依照螢幕上的指示和提示，將檔案儲存至電腦。
3. 從儲存軟體檔案的資料夾啟動軟體檔案。



### 方法 2：從印表機支援網站下載 (Windows 和 OS X)

1. 前往 [www.hp.com/support/ljm129MFP](http://www.hp.com/support/ljm129MFP)。
2. 選擇 **Software and drivers** (軟體與驅動程式)。
3. 下載適用於您印表機型號和作業系統的軟體。
4. 從儲存軟體檔案的資料夾啟動軟體檔案。



### 方法 3：從印表機光碟安裝 (僅限 Windows)

1. 將印表機光碟插入電腦中。
2. 依照螢幕上的指示安裝軟體。如需詳細資訊，請參閱印表機光碟上的「安裝注意事項」。

#### Readiris Pro for HP

下載這個免費軟體以啟用其他掃描功能，包括光學字元辨識 (OCR)。

若要從網路下載軟體，請前往：[www.hp.com/support/ljm129MFP](http://www.hp.com/support/ljm129MFP)

選擇 **Drivers** (驅動程式)，選擇適當的作業系統，然後按一下 **Next** (下一步)。按一下 **Application - 3rd Party** (應用程式 - 協力廠商)，然後按一下 **Download** (下載) 按鈕。

## 7. 行動列印 (選用)

### 7.1 將裝置連接至無線網路

若要從手機或平板電腦列印，請將裝置連接到與印表機相同的無線網路。

**Apple iOS 裝置 (AirPrint):** 開啟要列印的項目，並選擇動作圖示。選擇**列印**，選擇印表機，然後選擇**列印**。

**Android 裝置 (4.4 或更新版本):** 開啟要列印的項目，並選擇**選單**按鈕。選擇**列印**，選擇印表機，然後選擇**列印**。

某些裝置需要從 Google Play 商店下載 HP Print Service 外掛應用程式。

**Windows Phone:** 從 Windows 市集下載 HP AiO Remote 應用程式。

#### 進一步了解行動列印

如需有關這些和其他作業系統 (Chrome/Google 雲端列印) 的更多資訊，請前往 [www.hp.com/go/LaserJetMobilePrinting](http://www.hp.com/go/LaserJetMobilePrinting)，或掃描以下的 QR 碼。



### 7.2 Wi-Fi Direct (僅限無線機型)

Wi-Fi Direct 可讓您直接從無線行動裝置，對具備 Wi-Fi Direct 功能的印表機進行近距離列印，而不需要連接至網路或網際網路。

#### 啟用 Wi-Fi Direct

若要從控制面板啟用 Wi-Fi Direct，請完成下列步驟。

1. **雙行控制面板：**在印表機控制面板上，按下「設定」按鈕，接著開啟「網路設定」功能表。  
**觸控螢幕控制面板：**在印表機控制面板的主畫面中，選擇「連線資訊」產品/按鈕。  
2. 開啟下列功能表：
  - **Wi-Fi Direct**
  - **設定** (僅限觸控螢幕控制面板)
  - **開/關**
3. 點選**開啟**功能表項目。點選**關閉**按鈕會停用 Wi-Fi Direct 列印。

如需無線列印及無線設定的詳細資訊，請前往 [www.hp.com/go/wirelessprinting](http://www.hp.com/go/wirelessprinting)。

#### 探索印表機

1. 在行動裝置上，開啟 Wi-Fi，然後搜尋無線網路。
2. 選擇印表機，其顯示名稱將如印表機控制面板上所示的「Direct-機型-名稱」。印表機名稱範例：「Direct-bb-HP M277 Laserjet」。

## 8. 設定 HP ePrint via email (選用)



使用 HP ePrint via email，您只要在任何具備電子郵件功能的裝置上，將文件當做電子郵件附件傳送至印表機的電子郵件地址即可列印該文件，即使您使用的裝置不在同一個網路上也沒問題。

若要使用 HP ePrint via email，印表機必須符合以下要求：

- 印表機必須連線到有線或無線網路，且必須能夠存取網際網路。
- 印表機必須啟用 HP Web 服務，而且您必須已向 HP Connected 註冊印表機。

#### 啟用 HP Web 服務

##### 雙行 LCD 控制面板

1. 印表機連接至網路後，請在網頁瀏覽器的網址列中輸入印表機的網路 IP 位址。使用下列其中一個選項尋找印表機 IP：
  - 前往入門指南中的「尋找印表機 IP 位址」
  - 參閱使用指南
2. 在出現的網頁上，按一下 **HP Web 服務** 標籤。
3. 檢閱並接受使用條款，然後按一下 **啟用** 按鈕。

##### 觸控螢幕控制面板

1. 在印表機控制面板的主畫面中，點選 **Web 服務** 按鈕。
2. 點選 **啟用 Web 服務** 按鈕。印表機隨即啟用 Web 服務，然後列印資訊頁。資訊頁包含向 HP Connected 註冊 HP 印表機所需的印表機代碼。
3. 前往 [www.hpconnected.com](http://www.hpconnected.com)，建立 HP ePrint 帳戶並完成設定程序。

## 9. 設定傳真（僅限傳真機型 - 選用）

### 9.1 連接印表機

印表機為類比裝置。HP 建議在專用類比電話線路上使用印表機。

 **附註：**有些國家/地區可能需要為印表機隨附的電話線準備轉接器。

將印表機隨附的電話線連接到印表機上的傳真  連接埠和牆上的電話插座。

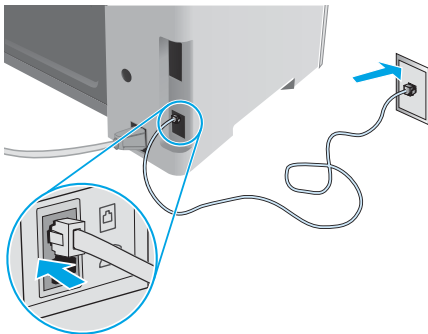

#### ❶ 如何連接答錄機或電話分機？

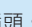
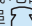
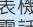
1. 從電話連接埠  取下插頭。
2. 將答錄機電話線從電話插座拔除，然後連接到印表機上的電話連接埠 。
3. 將印表機隨附的電話線連接到印表機上的傳真連接埠  和牆上的電話插座。

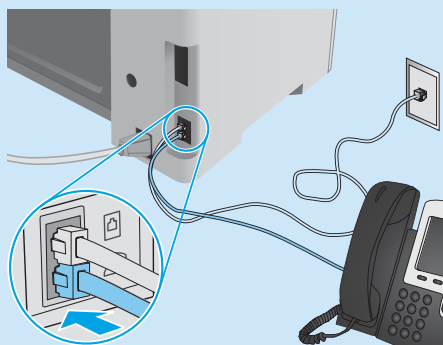

#### ❶ 如何在數位電話環境中設定 HP 印表機？

HP 印表機是專為搭配傳統類比電話服務而設計。進行印表機的傳真設定時，數位電話環境（例如 DSL/ADSL、PBX、ISDN 或 FoIP）可能需要數位轉類比過濾器或轉換器。

**附註：**視電話公司而定，印表機並非與所有的數位服務線路或供應商、所有的數位環境或所有的數位轉類比轉換器都能相容。請聯絡電話公司以判斷哪些設定選項最適合。

**附註：**在內部和外部通話有不同鈴聲模式的 PBX 電話系統中設定鈴聲模式偵測時，請務必使用外線電話號碼撥打印表機傳真號碼，以便錄製鈴聲模式。

### 9.2 設定印表機

若要使用傳真功能，必須設定傳真時間、日期及標題設定。

#### HP 傳真設定精靈 (Windows)

1. 按一下 **開始**，然後按一下 **程式集**。
2. 依序按一下 **HP**、印表機名稱與 **傳真設定精靈**。
3. 按照螢幕上的指示設定傳真設定值。

#### 雙行 LCD 控制面板

1. 在印表機控制面板上，按下「設定」 按鈕。
2. 選擇 **系統設定**，然後選擇 **時間/日期**。
3. 選擇 **時間/日期**。
4. 選擇 **12-hour**（12 小時制）或 **24-hour**（24 小時制）。
5. 使用鍵盤輸入目前時間，然後按下 **確定** 按鈕。
6. 選擇日期格式。
7. 使用鍵盤輸入目前日期，然後按下 **確定** 按鈕。
8. 在 **設定** 功能表中，選擇 **傳真設定**，然後選擇 **傳真標題**。
9. 使用鍵盤輸入傳真號碼，然後按下 **確定** 按鈕。

 **附註：**傳真號碼的字元數最多為 20 個。

10. 使用鍵盤輸入公司名稱或標題，然後按下 **確定** 按鈕。

 **附註：**傳真標題的字元數最多為 40 個。

#### 觸控螢幕控制面板

1. 在印表機控制面板的主畫面中，點選「設定」 按鈕。
  2. 選擇 **傳真設定**，然後選擇 **基本設定**。
  3. 選擇 **時間/日期**。
  4. 選擇 **12-hour**（12 小時制）或 **24-hour**（24 小時制）。
  5. 使用鍵盤輸入目前時間，然後點選 **確定** 按鈕。
  6. 選擇日期格式。
  7. 使用鍵盤輸入目前日期，然後點選 **確定** 按鈕。
  8. 選擇 **傳真標題**。
  9. 使用鍵盤輸入傳真號碼，然後點選 **確定** 按鈕。
  10. 使用鍵盤輸入公司名稱或標題，然後點選 **確定** 按鈕。
- 若要輸入標準鍵盤上沒有的特殊字元，請點選 **@#\$** 按鈕以開啟包含特殊字元的鍵盤。

 **附註：**傳真標題的字元數最多為 40 個。

#### ❶ 告訴我更多資訊！

如需其他傳真傳送方式（例如排定在日後傳送傳真或從電腦傳送傳真）的詳細資訊，請參閱印表機光碟上的使用指南，或前往：[www.hp.com/support/ijm129MFP](http://www.hp.com/support/ijm129MFP)

## 10. 使用掃描功能

使用電腦上的 HP Scan 軟體啟動印表機的掃描工作。

### Windows

開啟 HP Printer Assistant，選擇**掃描**，然後選擇**掃描文件或相片**。

### OS X

按一下**應用程式**，選擇**HP**，然後選擇**HP Easy Scan**。

## 疑難排解

### 使用指南

使用指南包含印表機使用方式及疑難排解資訊。這可在印表機光碟或網路上取得：

1. 前往：[www.hp.com/support/ijM129MFP](http://www.hp.com/support/ijM129MFP)
2. 從清單選擇印表機或類別，然後按一下**Drivers**（驅動程式）。
3. 選擇作業系統，然後按一下**Next**（下一步）按鈕。
4. 選擇**Firmware**（韌體），然後按一下**Download**（下載）按鈕。

### 檢查韌體更新

1. 前往：[www.hp.com/support/ijM129MFP](http://www.hp.com/support/ijM129MFP)
2. 從清單選擇印表機或類別，然後按一下**Drivers**（驅動程式）。
3. 選擇作業系統，然後按一下**Next**（下一步）按鈕。
4. 選擇**Firmware**（韌體），然後按一下**Download**（下載）按鈕。

### 控制面板說明（僅限觸控螢幕機型）

點選印表機控制面板上的「說明」？按鈕以存取說明主題。



### 解析錯誤碼訊息

#### 指示燈狀態

注意指示燈閃爍



#### 錯誤碼

Er/01



#### 動作

將紙張裝入紙匣

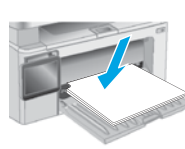

### 其他支援資源

如需印表機的 HP 全方位說明，請前往：[www.hp.com/support/ijM129MFP](http://www.hp.com/support/ijM129MFP)

- 解決問題
- 尋找進階組態設定指示
- 下載軟體更新
- 加入支援論壇
- 尋找保固及法規資訊
- 存取行動列印資源

### 有線（乙太網路）網路連線（選用）

- 確認印表機以長度合適的纜線連接到正確的網路連接埠。
- 確認網路連接埠旁邊的指示燈已亮起。
- 確認電腦已安裝列印驅動程式。
- 使用 Ping 指令偵測網路以測試網路通訊：

#### Windows

按一下**開始** > **執行**。輸入 **cmd**，並按下 **ENTER**。依序輸入 **ping**、空格、印表機 IP 位址，然後按下 **ENTER**。**IP 位址範例**：192.168.0.1。若要尋找印表機 IP，請參閱「尋找印表機 IP 位址」。

#### OS X

開啟「網路工具程式」，並在 **ping** 窗格中輸入 IP 位址。按下 **ENTER**。**IP 位址範例**：192.168.0.1。若要尋找印表機 IP，請參閱「尋找印表機 IP 位址」。

- 如果視窗顯示往返時間，表示網路運作正常。
- 如果 Ping 沒有作用，請嘗試重新啟動印表機，再重新檢查所有的連線步驟。

### 無線網路連線（僅限無線機型）

- 確認未連接網路線。當網路線已連接時，印表機無法連接至無線網路。
- 確認印表機和無線路由器已開啟且接通電源。此外，確定無線開關已開啟。
- 確認印表機位於無線網路範圍內。對多數網路而言，印表機必須是在距離無線存取點（無線路由器）30 公尺（100 英尺）以內的位置。
- 確認電腦已安裝列印驅動程式。
- 確認電腦和印表機連接至相同的無線網路。
- 若是使用 Mac，請確認無線路由器支援 Bonjour。
- 重新啟動無線路由器。

### 傳真疑難排解（僅限 fn、fp 和 fw 機型）

#### 檢查實體連線

- 確認電話線已連接到印表機背面傳真連接埠和牆上插座。
- 對於電話分機或其他附加裝置，請確認電話線已連接到印表機背面電話連接埠和裝置。
- 如果因為偵測不到撥號音或在忙線中而無法對外撥打電話，請連接到不同的電話線路。
- 若是使用網路傳真 (Fax over IP) 服務，請降低**傳真速度**，並關閉**錯誤更正模式**（位於印表機控制面板上的**傳真設定**功能表中）。

#### 檢查印表機傳真設定

- 若要使用電話公司或服務供應商提供的語音信箱服務，請確定印表機**接聽鈴聲次數**設定所設定的鈴聲次數比電話答錄機的還要少。
- 如果已將多組電話號碼指定給同一條實體電話線路，而且有多台裝置共用該線路時，請確定印表機設定了正確的區別鈴聲設定。使用一個會讓印表機接聽傳真而忽略其他鈴聲類型的設定。
- 將「傳真速度」設定設為**中等 (V.17)** 或**慢速 (V.29)**，也可以改善傳送傳真的功能。



# Hướng dẫn Bắt đầu Sử dụng LaserJet Pro MFP M129-M132, LaserJet Ultra MFP M133-M134

English.....1

Bahasa Indonesia.....5

한국어 .....9

ไทย ..... 13

繁體中文..... 17

Tiếng Việt ..... 21

## ! QUAN TRỌNG:

Hãy làm theo **Bước 1-3** trên áp phích hướng dẫn thiết lập phần cứng máy in, sau đó tiếp tục với **Bước 4**.



[www.hp.com/support/ljm129MFP](http://www.hp.com/support/ljm129MFP)



[www.register.hp.com](http://www.register.hp.com)



## 4. Thiết lập bảng điều khiển

Trên bảng điều khiển máy in, kiểm tra trạng thái hiển thị trước khi bắt đầu cài đặt phần mềm.

## 5. Chọn phương thức kết nối



### Kết nối USB trực tiếp giữa máy in và máy tính

Sử dụng cáp USB loại A-đến-B.

#### Windows

1. Không kết nối cáp USB trước khi cài đặt phần mềm. Quy trình cài đặt sẽ nhắc bạn nối cáp vào thời điểm phù hợp. Nếu đã nối cáp, hãy khởi động lại máy in khi quá trình cài đặt nhắc bạn nối cáp.
2. Tiếp tục bước **"6. Tải xuống và cài đặt phần mềm"**.

#### OS X

1. Nối cáp USB giữa máy tính và máy in trước khi cài đặt phần mềm.
2. Tiếp tục bước **"6. Tải xuống và cài đặt phần mềm"**.



### Kết nối mạng có dây (Ethernet) (Tùy chọn)

Sử dụng cáp mạng tiêu chuẩn.

1. Cắm cáp mạng vào máy in và vào mạng. Đợi vài phút để máy in xác định địa chỉ mạng.
2. Tiếp tục bước **"6. Tải xuống và cài đặt phần mềm"**.



### Kết nối mạng không dây (Chỉ dành cho kiểu máy hỗ trợ không dây)

#### Bảng điều khiển màn hình cảm ứng

1. Để kết nối máy in với mạng không dây (Wi-Fi), hãy chạm vào nút Wireless (Không dây) trên bảng điều khiển máy in.
2. Chạm vào **Wireless Menu** (Menu Không dây), sau đó chạm vào **Wireless Setup Wizard** (Trình hướng dẫn Thiết lập Không dây). Chọn tên mạng từ danh sách SSID hoặc nhập tên mạng nếu tên này không được liệt kê.
3. Sử dụng bàn phím để nhập cụm mật khẩu, sau đó chạm vào nút **OK**.
4. Đợi máy in thiết lập kết nối mạng.
5. Trên bảng điều khiển máy in, chạm vào nút Network (Mạng). Nếu thấy địa chỉ IP được liệt kê thì có nghĩa là kết nối mạng đã được thiết lập. Nếu bạn không thấy, hãy đợi vài phút và thử lại. Ghi lại địa chỉ IP để sử dụng trong khi cài đặt phần mềm. **Ví dụ về địa chỉ IP:** 192.168.0.1

#### Bảng điều khiển 2 dòng/LED

1. Để kết nối máy in với mạng không dây (Wi-Fi), hãy đảm bảo rằng bạn đã bật máy in, điểm truy cập và máy tính cũng như đã kết nối máy tính với mạng không dây.
2. Có thể cần sử dụng cáp USB trong quá trình cài đặt phần mềm.
3. Để in từ máy tính, hãy tiếp tục bước **"6. Tải xuống và cài đặt phần mềm"**. Để chỉ in từ điện thoại hoặc máy tính bảng, hãy tiếp tục với bước **"7. In từ thiết bị di động (tùy chọn)"**.

### ! Đặt cấu hình địa chỉ IP theo cách thủ công

Hãy xem hướng dẫn sử dụng máy in để biết thông tin về cách đặt cấu hình thủ công địa chỉ IP [www.hp.com/support/ljm129MFP](http://www.hp.com/support/ljm129MFP).



## 6. Tải xuống và cài đặt phần mềm



### Cách 1: Tải xuống HP Easy Start (Windows và OS X)

1. Truy cập [123.hp.com/laserjet](http://123.hp.com/laserjet) và nhấp vào **Download** (Tải xuống).
2. Làm theo hướng dẫn và lời nhắc trên màn hình để lưu tệp vào máy tính.
3. Khởi chạy tệp phần mềm từ thư mục bạn đã lưu tệp.



### Cách 2: Tải xuống từ trang web hỗ trợ máy in (Windows và OS X)

1. Truy cập [www.hp.com/support/ljM129MFP](http://www.hp.com/support/ljM129MFP).
2. Chọn **Software and drivers** (Phần mềm và trình điều khiển).
3. Tải xuống phần mềm cho kiểu máy in và hệ điều hành của bạn.
4. Khởi chạy tệp phần mềm từ thư mục bạn đã lưu tệp.



### Cách 3: Cài đặt từ đĩa CD máy in (chỉ dành cho Windows)

1. Đưa đĩa CD máy in vào máy tính.
2. Làm theo hướng dẫn trên màn hình để cài đặt phần mềm. Để biết thêm thông tin, hãy xem Ghi chú Cài đặt trên CD máy in.

#### Readiris Pro dành cho HP

Hãy tải xuống phần mềm miễn phí này để bật các tính năng quét khác, kể cả Optical Character Recognition (OCR) (Nhận dạng Ký tự Quang).

Để tải xuống phần mềm từ web, hãy truy cập:

[www.hp.com/support/ljM129MFP](http://www.hp.com/support/ljM129MFP)

Chọn **Drivers** (Trình điều khiển), chọn hệ điều hành phù hợp, sau đó nhấp vào **Next** (Tiếp). Nhấp vào **Application - 3rd Party** (Ứng dụng - Bên thứ 3), sau đó nhấp vào nút **Download** (Tải xuống).

## 7. In từ thiết bị di động (tùy chọn)

### 7.1 Kết nối thiết bị với mạng không dây

Để in từ điện thoại hoặc máy tính bảng, hãy kết nối thiết bị với cùng một mạng không dây như máy in.

**Thiết bị iOS của Apple (AirPrint):** Mở mục cần in và chọn biểu tượng Action (Tác vụ). Chọn **Print** (In), chọn máy in, sau đó chọn **Print** (In).

**Thiết bị Android (4.4 trở lên):** Mở mục cần in và chọn nút **Menu**. Chọn **Print** (In), chọn máy in, sau đó chọn **Print** (In).

Một số thiết bị yêu cầu tải xuống ứng dụng phần hỗ trợ HP Print Service từ Cửa hàng Google Play.

**Windows Phone:** Tải xuống ứng dụng HP AiO Remote từ Windows Store.

#### 📄 Tìm hiểu thêm về tính năng in từ thiết bị di động

Để biết thêm thông tin về những tính năng này và các hệ điều hành khác (Chrome/Google Cloud Print), hãy truy cập "[www.hp.com/go/LaserJetMobilePrinting](http://www.hp.com/go/LaserJetMobilePrinting)" hoặc quét mã QR bên dưới.



### 7.2 Wi-Fi Direct (Chỉ dành cho kiểu máy hỗ trợ không dây)

Wi-Fi Direct cho phép bạn in trong phạm vi gần, trực tiếp từ thiết bị di động không dây tới máy in hỗ trợ Wi-Fi Direct, mà không cần kết nối mạng hoặc Internet.

#### Bật Wi-Fi Direct

Để bật Wi-Fi Direct từ bảng điều khiển máy in, hãy hoàn thành các bước sau.

1. **Bảng điều khiển 2 dòng:** Trên bảng điều khiển máy in, nhấn nút Setup (Thiết lập) rồi mở menu Network Setup (Thiết lập Mạng). **Bảng điều khiển màn hình cảm ứng:** Từ Màn hình chính trên bảng điều khiển của máy in, chạm vào nút Connection Information (Thông tin Kết nối) .
2. Mở các menu sau:
  - **Wi-Fi Direct**
  - **Settings (Cài đặt)** (Chỉ có ở bảng điều khiển màn hình cảm ứng)
  - **On/Off (Bật/Tắt)**
3. Chạm vào mục **On** (Bật) trên menu. Chạm vào nút **Off** (Tắt) sẽ tắt tính năng in Wi-Fi Direct.

📄 Để biết thêm thông tin về cách thiết lập mạng không dây và in không dây, hãy truy cập [www.hp.com/go/wirelessprinting](http://www.hp.com/go/wirelessprinting).

#### Phát hiện máy in

1. Từ thiết bị di động, bật Wi-Fi và tìm mạng không dây.
2. Chọn máy in. Tên máy in sẽ xuất hiện dưới dạng: "Direct-kiểu máy-tên" như hiển thị trên bảng điều khiển máy in.  
**Ví dụ:** "Direct-bb-HP M277 Laserjet".

## 8. Thiết lập HP ePrint qua email (tùy chọn)



Sử dụng HP ePrint qua email để in tài liệu bằng cách gửi tài liệu dưới dạng tệp đính kèm trong email đến địa chỉ email của máy in từ bất kỳ thiết bị nào hỗ trợ email, thậm chí từ các thiết bị không sử dụng cùng một mạng.

Để sử dụng HP ePrint qua email, máy in phải đáp ứng những yêu cầu sau:

- Máy in phải được kết nối với mạng không dây hoặc có dây và có quyền truy cập vào Internet.
- Máy in phải bật HP Web Services (Dịch vụ Web của HP) và phải được đăng ký với HP Connected.

### Bật HP Web Services (Dịch vụ Web của HP)

#### Bảng điều khiển LCD 2 dòng

1. Sau khi máy in được kết nối với mạng, nhập địa chỉ IP của máy in trên mạng vào trình duyệt web. Sử dụng một trong các tùy chọn sau để tìm IP của máy in:
  - Chuyển đến phần "Tìm địa chỉ IP của máy in" trong hướng dẫn bắt đầu sử dụng này
  - Tham khảo hướng dẫn sử dụng
2. Trên trang web xuất hiện, nhấp vào tab **HP Web Services** (Dịch vụ Web của HP).
3. Đọc và chấp nhận điều khoản sử dụng, sau đó nhấp vào nút **Enable** (Bật).

#### Bảng điều khiển màn hình cảm ứng

1. Từ Màn hình chính trên bảng điều khiển máy in, chạm vào nút **Web Services** (Dịch vụ Web).
2. Chạm vào nút **Enable Web Services** (Bật dịch vụ Web). Máy in sẽ bật Web Services (Dịch vụ Web), sau đó in trang thông tin. Trang thông tin có chứa mã máy in cần thiết để bạn đăng ký máy in HP tại HP Connected.
3. Truy cập [www.hpconnected.com](http://www.hpconnected.com) để tạo tài khoản HP ePrint và hoàn tất quy trình thiết lập.



## 9. Thiết lập fax (Chỉ dành cho kiểu máy hỗ trợ fax - tùy chọn)

### 9.1 Kết nối máy in

Máy in là thiết bị analog. HP khuyến bạn nên sử dụng máy in trên đường dây điện thoại analog chuyên dụng.

**LƯU Ý:** Bạn có thể phải sử dụng bộ điều hợp cho dây điện thoại đi kèm với máy in tại một số quốc gia/khu vực.

Cắm dây điện thoại đi kèm với máy in vào cổng Fax trên máy in và giắc cắm điện thoại trên tường.

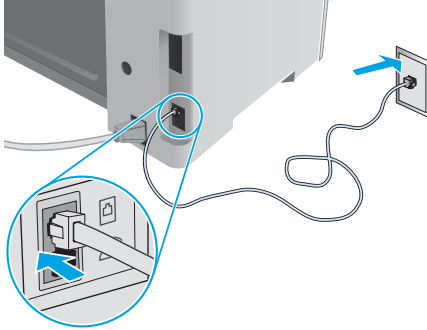

#### ❗ Làm thế nào để kết nối máy trả lời hoặc điện thoại nhánh?

1. Rút phích cắm ra khỏi cổng điện thoại.
2. Rút dây điện thoại của máy trả lời khỏi giắc điện thoại, sau đó cắm dây đó vào cổng điện thoại trên máy in.
3. Cắm dây điện thoại đi kèm với máy in vào cổng fax trên máy in và giắc cắm điện thoại trên tường.

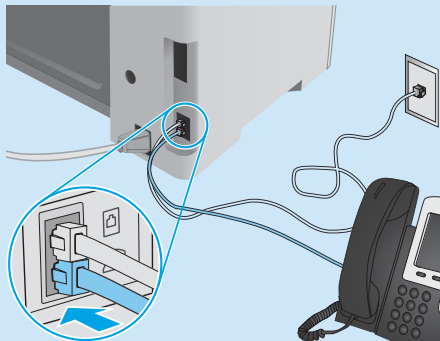

#### ❗ Làm thế nào để thiết lập máy in HP trong môi trường điện thoại kỹ thuật số?

Các máy in HP được thiết kế riêng để sử dụng với dịch vụ điện thoại analog truyền thống. Đối với môi trường điện thoại kỹ thuật số (như: DSL/ADSL, PBX, ISDN hay FoIP), bạn có thể cần dùng đến bộ lọc hoặc bộ chuyển đổi tín hiệu kỹ thuật số thành analog khi thiết lập chức năng fax cho máy in.

**Lưu ý:** Tùy theo công ty điện thoại, có thể máy in không tương thích với tất cả các đường dây hoặc nhà cung cấp dịch vụ kỹ thuật số, trong tất cả các môi trường kỹ thuật số hoặc với tất cả các bộ chuyển đổi tín hiệu kỹ thuật số thành analog. Hãy liên hệ với công ty điện thoại để xác định xem tùy chọn thiết lập nào là phù hợp nhất.

**Lưu ý:** Khi thiết lập chức năng dò tìm mẫu chuông trong hệ thống điện thoại PBX sử dụng mẫu chuông khác nhau cho cuộc gọi nội bộ và từ bên ngoài, hãy bảo đảm rằng bạn quay số fax của máy in bằng số bên ngoài để ghi lại mẫu chuông.

### 9.2 Đặt cấu hình máy in

Bạn phải đặt cấu hình các cài đặt ngày, giờ và tiêu đề fax để sử dụng chức năng fax.

#### HP Fax Setup Wizard (Trình hướng dẫn Thiết lập Fax của HP) (Windows)

1. Nhấp vào **Start** (Bắt đầu), sau đó nhấp vào **Programs** (Chương trình).
2. Nhấp vào **HP**, nhấp vào tên của máy in, sau đó nhấp vào **Fax Setup Wizard** (Trình hướng dẫn Thiết lập Fax).
3. Làm theo hướng dẫn trên màn hình để đặt cấu hình cài đặt fax.

#### Bảng điều khiển LCD 2 dòng

1. Trên bảng điều khiển máy in, bấm nút **Setup** (Thiết lập).
2. Chọn **System Setup** (Thiết lập Hệ thống), sau đó chọn **Time/Date** (Ngày/Giờ).
3. Chọn **Time/Date** (Ngày/Giờ).
4. Chọn **12-hour** (12 giờ) hoặc **24-hour** (24 giờ).
5. Sử dụng bàn phím để nhập thời gian hiện tại, sau đó nhấn nút **OK**.
6. Chọn định dạng ngày.
7. Sử dụng bàn phím để nhập ngày hiện tại, sau đó nhấn nút **OK**.
8. Từ menu **Setup** (Thiết lập), chọn **Fax Setup** (Thiết lập Fax), sau đó chọn **Fax Header** (Tiêu đề Fax).
9. Sử dụng bàn phím để nhập số fax, sau đó nhấn nút **OK**.

**LƯU Ý:** Số fax không được dài quá 20 ký tự.

10. Sử dụng bàn phím để nhập tên công ty hoặc tiêu đề, sau đó nhấn nút **OK**.

**LƯU Ý:** Tiêu đề fax không được dài quá 40 ký tự.

#### Bảng điều khiển màn hình cảm ứng

1. Từ Màn hình chính trên bảng điều khiển máy in, chạm vào nút **Setup** (Thiết lập).
2. Chọn **Fax Setup** (Thiết lập Fax), sau đó chọn **Basic Setup** (Thiết lập Cơ bản).
3. Chọn **Time/Date** (Ngày/Giờ).
4. Chọn **12-hour** (12 giờ) hoặc **24-hour** (24 giờ).
5. Sử dụng bàn phím để nhập thời gian hiện tại, sau đó chạm vào nút **OK**.
6. Chọn định dạng ngày.
7. Sử dụng bàn phím để nhập ngày hiện tại, sau đó chạm vào nút **OK**.
8. Chọn **Fax Header** (Tiêu đề Fax).
9. Sử dụng bàn phím để nhập số fax, sau đó chạm vào nút **OK**.

**LƯU Ý:** Số fax không được dài quá 20 ký tự.

10. Sử dụng bàn phím để nhập tên công ty hoặc tiêu đề, sau đó chạm vào nút **OK**.

Để nhập ký tự đặc biệt không có trên bàn phím tiêu chuẩn, chạm vào nút **@#\$** để mở bàn phím có chứa ký tự đặc biệt.

**LƯU Ý:** Tiêu đề fax không được dài quá 40 ký tự.

#### ❗ Hãy tìm hiểu thêm!

Để biết thêm thông tin về các cách gửi fax khác, như lên lịch để gửi fax sau hay gửi fax từ máy tính, hãy xem hướng dẫn sử dụng trên CD máy in hoặc truy cập: [www.hp.com/support/li129MFP](http://www.hp.com/support/li129MFP)

## 10. Sử dụng tính năng quét

Sử dụng phần mềm HP Scan trên máy tính của bạn để bắt đầu công việc quét trên máy in.

### Windows

Mở HP Printer Assistant (Trợ lý Máy in HP), chọn **Scan** (Quét), rồi chọn **Scan a Document or Photo** (Quét Tài liệu hoặc Ảnh).

### OS X

Nhấp vào **Applications** (Ứng dụng), chọn **HP**, rồi chọn **HP Easy Scan**.

## Khắc phục sự cố

### Hướng dẫn sử dụng

Hướng dẫn sử dụng chứa thông tin về cách sử dụng và khắc phục sự cố với máy in. Hướng dẫn này có trên CD máy in và trên web:

1. Hãy truy cập: [www.hp.com/support/liM129MFP](http://www.hp.com/support/liM129MFP).
2. Chọn ngôn ngữ thích hợp, rồi chọn máy in nếu được nhắc, sau đó nhấp vào **User Guides** (Hướng dẫn Sử dụng).

### Kiểm tra bản cập nhật của chương trình cơ sở

1. Hãy truy cập: [www.hp.com/support/liM129MFP](http://www.hp.com/support/liM129MFP)
2. Chọn máy in hoặc danh mục từ danh sách, sau đó nhấp vào **Drivers** (Trình điều khiển).
3. Chọn hệ điều hành và nhấp vào nút **Next** (Tiếp).
4. Chọn **Firmware** (Chương trình cơ sở) và nhấp vào nút **Download** (Tải xuống).

### Trợ giúp bằng điều khiển

#### (Chỉ dành cho kiểu máy màn hình cảm ứng)

Chạm vào nút Help (Trợ giúp) ? trên bảng điều khiển máy in để truy cập các chủ đề trợ giúp.

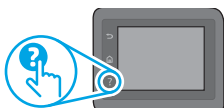

### Xử lý thông báo mã lỗi

#### Trạng thái của Đèn

Đèn Cảnh báo đang nhấp nháy



#### Mã lỗi

Er/01



#### Thao tác

Nạp giấy vào khay

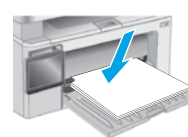

### Tài nguyên hỗ trợ bổ sung

Để xem phần trợ giúp toàn diện của HP dành cho máy in, hãy truy cập: [www.hp.com/support/liM129MFP](http://www.hp.com/support/liM129MFP)

- Giải quyết sự cố
- Tìm hướng dẫn cấu hình nâng cao
- Tải xuống bản cập nhật phần mềm
- Tham gia các diễn đàn hỗ trợ
- Tìm thông tin về quy định và bảo hành
- Truy cập tài nguyên về in từ thiết bị di động



## Kết nối mạng có dây (Ethernet) (Tùy chọn)

- Xác minh rằng máy in đã được kết nối với đúng cổng mạng bằng cáp có độ dài phù hợp.
- Xác minh rằng các đèn bên cạnh cổng mạng đều sáng.
- Xác minh rằng trình điều khiển in đã được cài đặt trên máy tính.
- Kiểm tra kết nối mạng bằng cách ping mạng:

### Windows

Nhấp vào **Start** (Bắt đầu) > **Run** (Chạy). Nhập **cmd** và nhấn **ENTER**. Nhập **ping**, nhập khoảng trắng, nhập địa chỉ IP của máy in, sau đó nhấn **ENTER**.  
**Ví dụ về địa chỉ IP:** 192.168.0.1. Để tìm IP của máy in, hãy xem phần “Find the printer IP address” (Tìm địa chỉ IP của máy in).

### OS X

Mở Network Utility (Tiện ích Mạng) và nhập địa chỉ IP vào ngăn **ping**. Nhấn **ENTER**. **Ví dụ về địa chỉ IP:** 192.168.0.1. Để tìm IP của máy in, hãy xem phần “Find the printer IP address” (Tìm địa chỉ IP của máy in).

- Nếu cửa sổ hiển thị thời gian tròn vòng thì có nghĩa là mạng đang hoạt động.
- Nếu ping không hoạt động, hãy thử khởi động lại máy in và kiểm tra lại tất cả các bước kết nối.





## Kết nối mạng không dây (Chỉ dành cho kiểu máy hỗ trợ không dây)

- Xác minh rằng cáp mạng không được nối với máy in. Máy in không thể kết nối với mạng không dây khi đã cắm cáp mạng.
- Xác minh rằng máy in và bộ định tuyến không dây đã được bật và có điện. Ngoài ra, cũng đảm bảo rằng bạn đã bật chế độ không dây.
- Xác minh rằng máy in nằm trong phạm vi của mạng không dây. Đối với hầu hết các mạng, máy in phải nằm trong phạm vi 30 m (100 ft) từ điểm truy cập không dây (bộ định tuyến không dây).
- Xác minh rằng trình điều khiển in đã được cài đặt trên máy tính.
- Xác minh rằng máy tính và máy in được kết nối với cùng một mạng không dây.
- Đối với máy Mac, xác minh rằng bộ định tuyến không dây hỗ trợ Bonjour.
- Khởi động lại bộ định tuyến không dây.



## Khắc phục sự cố fax (Chỉ dành cho các kiểu máy fn, fp và fw)

### Xác minh kết nối thực tế

- Xác minh rằng dây điện thoại được cắm vào cổng fax  ở phía sau máy in và giắc cắm trên tường.
- Đối với điện thoại nhánh hoặc thiết bị bổ sung khác, hãy xác minh rằng dây điện thoại được cắm vào cổng điện thoại  ở phía sau máy in và vào thiết bị.
- Nếu bạn không thực hiện được cuộc gọi đi vì máy không dò tìm được âm hiệu quay số hay đường dây bận, hãy kết nối với đường dây điện thoại khác.
- Đối với dịch vụ Fax over IP (Fax qua IP), hãy giảm **Fax Speed** (Tốc độ Fax) và tắt **Error Correction Mode** (Chế độ Sửa Lỗi) từ menu **Fax Settings** (Cài đặt Fax) trên bảng điều khiển máy in.

### Xác minh cài đặt fax của máy in

- Để sử dụng dịch vụ thư thoại từ công ty điện thoại hoặc nhà cung cấp dịch vụ, hãy bảo đảm rằng cài đặt **Rings to Answer** (Số lần đổ chuông trước khi Trả lời) của máy in được đặt với số lần đổ chuông ít hơn so với máy trả lời tự động.
- Nếu có nhiều số điện thoại được dùng cho cùng một đường dây điện thoại thực tế và đường dây đó được dùng chung cho nhiều thiết bị, hãy bảo đảm rằng máy in được thiết lập với đúng cài đặt chuông riêng biệt. Sử dụng cài đặt sao cho máy in nhận fax và bỏ qua các loại chuông khác.
- Việc đặt cấu hình cài đặt Fax Speed (Tốc độ Fax) thành **Medium (V.17)** (Trung bình) hoặc **Slow (V.29)** (Thấp) cũng có thể giúp cải thiện khả năng gửi fax.





Reproduction, adaptation or translation without prior written permission is prohibited, except as allowed under the copyright laws.

The information contained herein is subject to change without notice.

The only warranties for HP products and services are set forth in the express warranty statements accompanying such products and services. Nothing herein should be construed as constituting an additional warranty. HP shall not be liable for technical or editorial errors or omissions contained herein.

### Trademark Credits

Windows® is a U.S. registered trademark of Microsoft Corporation.

Apple and the Apple logo are trademarks of Apple Inc., registered in the U.S. and other countries.

OS X is a trademark of Apple Inc., registered in the U.S. and other countries.

AirPrint is a trademark of Apple Inc., registered in the U.S. and other countries.

### FCC Regulations

This equipment has been tested and found to comply with the limits for a Class B digital device, pursuant to Part 15 of the FCC rules. These limits are designed to provide reasonable protection against harmful interference in a residential installation. This equipment generates, uses, and can radiate radio-frequency energy. If this equipment is not installed and used in accordance with the instructions, it may cause harmful interference to radio communications. However, there is no guarantee that interference will not occur in a particular installation. If this equipment does cause harmful interference to radio or television reception, which can be determined by turning the equipment off and on, correct the interference by one or more of the following measures:

- Reorient or relocate the receiving antenna.
- Increase separation between equipment and receiver.
- Connect equipment to an outlet on a circuit different from that to which the receiver is located.
- Consult your dealer or an experienced radio/TV technician.

Any changes or modifications to the product that are not expressly approved by HP could void the user's authority to operate this equipment. Use of a shielded interface cable is required to comply with the Class B limits of Part 15 of FCC rules. For more regulatory information, see the electronic user guide. HP shall not be liable for any direct, indirect, incidental, consequential, or other damage alleged in connection with the furnishing or use of this information.

