

# M585 / M590 SILENT

Setup Guide | 设置指南 | 設定指南 | 설치 가이드



logitech®

**3** ENGLISH

**7** 简体中文

**11** 繁體中文

**15** 한국어

## SYSTEM REQUIREMENTS

### Unifying USB Receiver

Available USB port  
Windows® 10 or later  
Windows® 8 or later  
Windows® 7 or later  
MAC OS X 10.10  
Chrome OS™  
Linux Kernel 2.6

### Bluetooth® Low Energy Technology

Windows® 10 or later  
Windows® 8 or later  
MAC OS X 10.10  
Chrome OS™  
Android 5.0 or later

### Logitech Options

Windows® 10,  
Windows 8, and  
Windows 7  
MAC OS X 10.10 or above

Logitech Flow requires a compatible mouse and at least two computers that can connect to each other over a local area network

## PRODUCT OVERVIEW

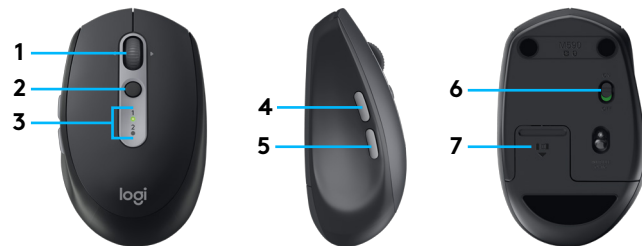

- 1 Scroll wheel button and tilt buttons
  - 2 Easy-Switch™ button
  - 3 Channel and battery indicator
  - 4 Forward button
  - 5 Back button
  - 6 On/Off slider
  - 7 Battery and Unifying receiver storage\*
- \* Unifying receiver inside

# CONNECT

## Bluetooth wireless technology

In case you have limited USB slots, you can connect your M585 or M590 Silent mouse to your computer using *Bluetooth*. For compatibility requirements, please refer to system requirements

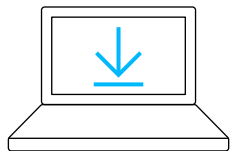

[www.logitech.com/options](http://www.logitech.com/options)

- 1 Download Logitech Options, click Add Devices, and select Add Bluetooth Device

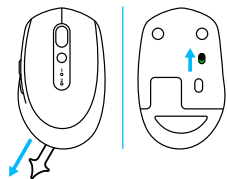

- 2 Remove pull tab or make sure your mouse is ON

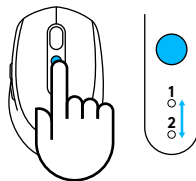

- 3 Short press Easy-Switch button to select desired channel

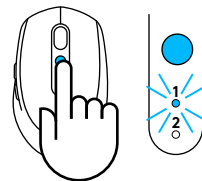

- 4 Long press Easy-Switch button to enter pairing mode

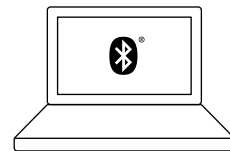

- 5 Find your M585/M90 mouse on the list of Bluetooth devices and connect

Logitech M585/M590 Silent can connect to one computer on the two provided channels using *Bluetooth*.

## Unifying USB receiver

One tiny receiver for up to six Unifying devices. Plug it and leave it, then connect additional mice and keyboards to one computer.

### First time out of the box

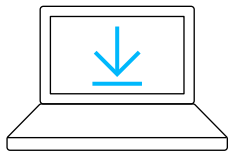

[www.logitech.com/options](http://www.logitech.com/options)

- 1 Download Logitech Options, click Add Devices, and select Add Unifying Device

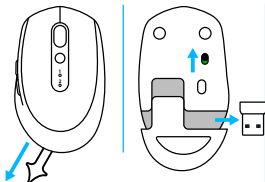

- 2 Remove pull tab or make sure your mouse is on and extract Unifying receiver from battery hatch

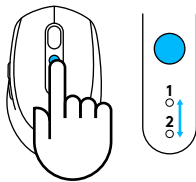

1 sec.

- 3 Short press Easy-Switch button to select desired channel

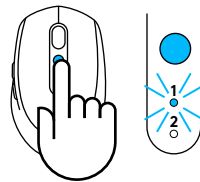

3 sec.

- 4 Long press Easy-Switch button to enter pairing mode

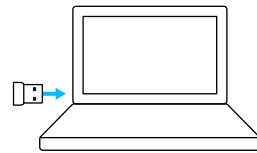

- 5 Insert Unifying USB receiver

### Repair with an existing Unifying receiver

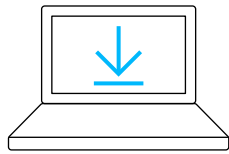

[www.logitech.com/unifying](http://www.logitech.com/unifying)

- 1 Download Logitech Unifying Software

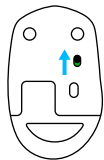

- 2 Make sure your mouse is On

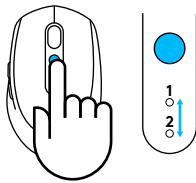

1 sec.

- 3 Short press Easy-Switch button to select desired channel

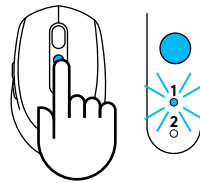

3 sec.

- 4 Long press Easy-Switch button to enter pairing mode

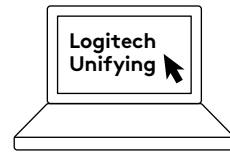

- 5 Open Unifying software and follow onscreen instructions

## Connecting to 2 systems

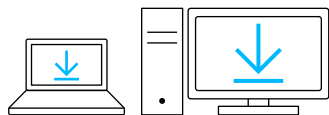

[www.logitech.com/options](http://www.logitech.com/options)

- 1 Download Logitech Options on both systems

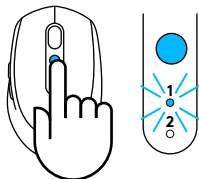

3 sec.

- 2 Make sure your mouse is On

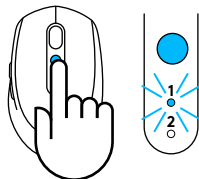

3 sec.

- 3 Long press Easy-Switch button to enter pairing mode



- 4 Connect to your first computer via either Unifying USB receiver or Bluetooth

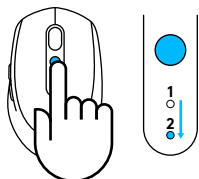

1 sec.

- 5 Short press Easy-Switch button to switch to next channel

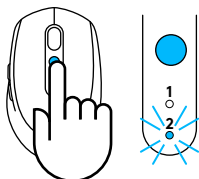

3 sec.

- 6 Long press Easy-Switch button to enter pairing mode



- 7 Connect to your second computer via Unifying USB receiver or Bluetooth

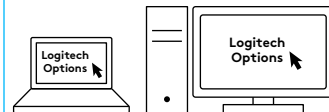

- 8 Enable FLOW through Logitech Options or press Easy-Switch button to switch between devices

Logitech M585/590 Silent can connect to up to two computers with either Bluetooth or Logitech Unifying receiver. One receiver is included in the box.

## 系统需求

### Unifying™ 优联 USB 接收器

可用 USB 端口

Windows® 10 或更高版本

Windows® 8 或更高版本

Windows® 7 或更高版本

MAC OS X 10.10

Chrome OS™

Linux Kernel 2.6

### 蓝牙™ 低功耗技术

Windows® 10 或更高版本

Windows® 8 或更高版本

MAC OS X 10.10

Chrome OS™

Android 5.0 或更高版本

### Logitech Options

Windows® 10、

Windows 8 和

Windows 7

MAC OS X 10.10 或更高版本

罗技 Flow 需要兼容鼠标和至少两台可通过局域网彼此连接的电脑

## 产品概览

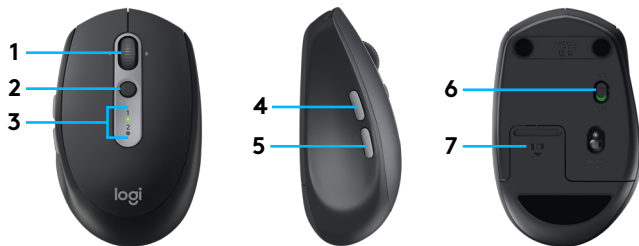

- 1 滚轮按钮和倾斜按钮
  - 2 易于切换™ 按钮
  - 3 信道和电池指示灯
  - 4 前进按钮
  - 5 后退按钮
  - 6 开启/关闭滑动开关
  - 7 电池和 Unifying™ 优联接收器存储\*
- \* Unifying™ 优联接收器在内部

# 连接

## 蓝牙无线技术

如果 USB 插口有限, 可通过 **蓝牙** 方式将 M585 或 M590 Silent 鼠标连接到电脑。  
有关兼容性要求, 请参见系统要求

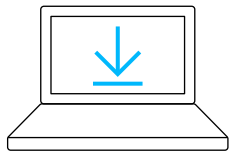

[www.logitech.com/options](http://www.logitech.com/options)

- 1 下载 Logitech Options, 单击“添加设备”并选择“添加蓝牙设备”

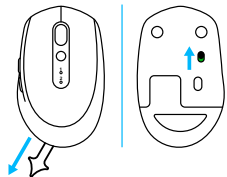

- 2 扯下拉带或确保鼠标已开启

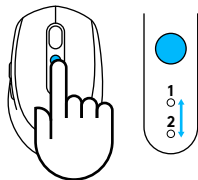

- 3 短按“易于切换”按钮来选择所需信道

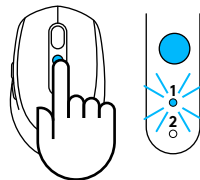

- 4 长按“易于切换”按钮来进入配对模式

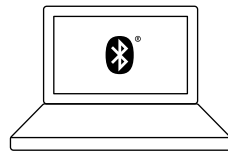

- 5 在蓝牙设备列表中找到 M585/M90 鼠标并连接

Logitech M585/M590 Silent 可提供两个信道并通过蓝牙连接到电脑上。



## Unifying™ 优联 USB 接收器

一个小小的接收器可同时连接多达六台罗技 Unifying™ 优联设备。插入即忘, 可再向同一台电脑连接其他鼠标和键盘。

### 首次开箱即用

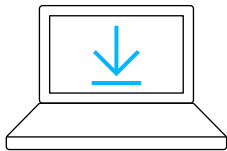

[www.logitech.com/options](http://www.logitech.com/options)

- 1 下载 Logitech Options, 单击“添加设备”并选择“添加 Unifying™ 优联设备”

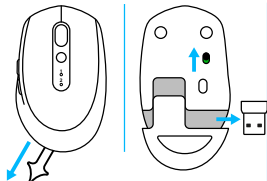

- 2 扯下拉带或确保鼠标已开启, 从电池仓中取出 Unifying™ 优联设备

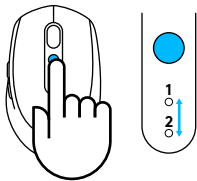

1 秒

- 3 短按“易于切换”按钮来选择所需信道

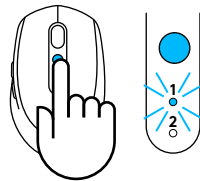

3 秒

- 4 长按“易于切换”按钮来进入配对模式

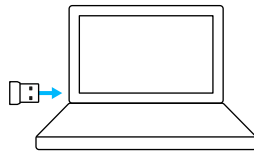

- 5 插入 Unifying™ 优联 USB 接收器

### 与现有 Unifying™ 优联接收器重新配对

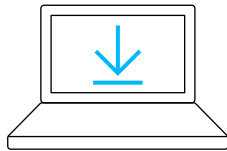

[www.logitech.com/unifying](http://www.logitech.com/unifying)

- 1 下载罗技 Unifying™ 优联软件

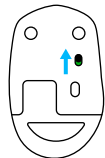

- 2 确保鼠标处于开启状态

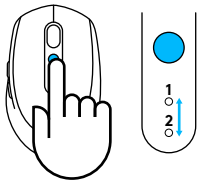

1 秒

- 3 短按“易于切换”按钮来选择所需信道

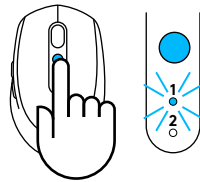

3 秒

- 4 长按“易于切换”按钮来进入配对模式

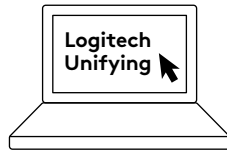

- 5 打开 Unifying™ 优联软件并按屏幕指示操作

## 连接到 2 个系统

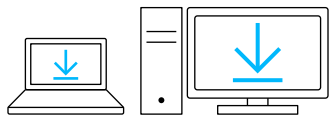

[www.logitech.com/options](http://www.logitech.com/options)

1 在两个系统上下载 Logitech Options

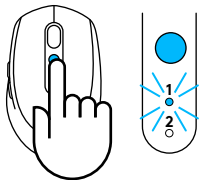

3 秒

2 确保鼠标处于开启状态

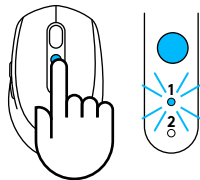

3 秒

3 长按“易于切换”按钮来进入配对模式

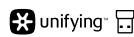

4 先通过 Unifying™ 优联 USB 接收器或蓝牙连接到一台电脑

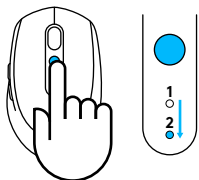

1 秒

5 短按“易于切换”按钮来切换到另一信道

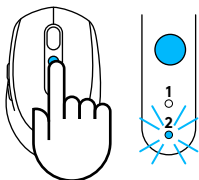

3 秒

6 长按“易于切换”按钮来进入配对模式

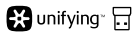

7 通过 Unifying™ 优联 USB 接收器或蓝牙连接到另一台电脑

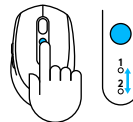
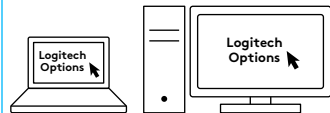

8 通过 Logitech Options 启用 FLOW，或按下“易于切换”按钮来切换设备

罗技 M585/590 Silent 可通过蓝牙或罗技 Unifying™ 优联接收器连接多达两台电脑。盒子已含一个接收器。

## 系統需求

### Unifying USB 接收器

可用的 USB 連接埠

Windows® 10 或更新版本

Windows® 8 或更新版本

Windows® 7 或更新版本

MAC OS X 10.10

Chrome OS™

Linux Kernel 2.6

### 藍牙低功耗技術

Windows® 10 或更新版本

Windows® 8 或更新版本

MAC OS X 10.10

Chrome OS™

Android 5.0 或更新版本

### Logitech Options

Windows® 10、

Windows 8、與

Windows 7

MAC OS X 10.10 或更高版本

羅技 Flow 需要有相容的滑鼠以及至少兩台可互相連線或透過區域網路連線的電腦。

## 產品概覽

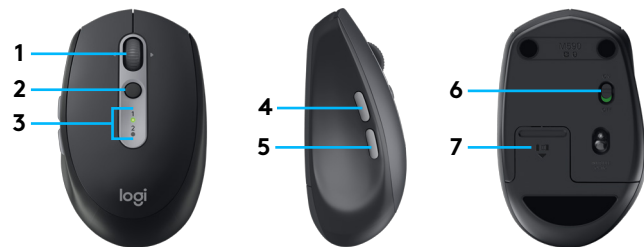

- 1 滾輪按鈕與傾斜按鈕
  - 2 Easy-Switch™ 按鈕
  - 3 頻道和電池指示燈
  - 4 前進按鈕
  - 5 後退按鈕
  - 6 電源開啓/關閉開關
  - 7 電池與 Unifying 接收器收藏槽\*
- \* 內含 Unifying 接收器

# 連線

## 藍牙無線技術

如果您的 USB 插槽有限，可以使用藍牙將 M585 或 M590 Silent 滑鼠連線到電腦。  
關於相容性的需求，請參閱系統需求

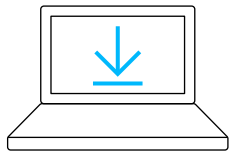

[www.logitech.com/options](http://www.logitech.com/options)

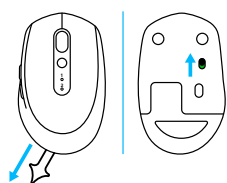

1 下載 Logitech Options，按一下「新增裝置」，然後選擇「新增藍牙裝置」

2 移除所有的拉條或確認滑鼠已開啓電源

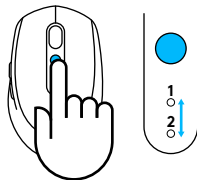

3 短按 Easy-Switch 按鈕可選擇想要的頻道

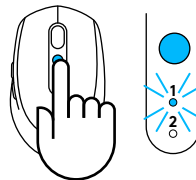

4 長按 Easy-Switch 按鈕可進入配對模式

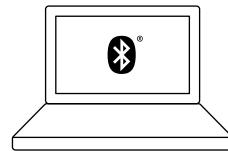

5 在藍牙裝置清單中找到 M585/M90 滑鼠然後連線

羅技 M585/M590 Silent 滑鼠可以使用藍牙透過兩個提供的頻道連線到一台電腦。

## Unifying USB 接收器

一個最多可配對六個 Unifying 裝置的超小型接收器 插入即忘，然後即可將其他滑鼠與鍵盤連線到一台電腦。

### 第一次開箱

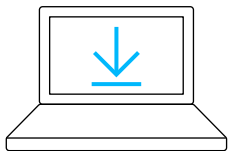

[www.logitech.com/options](http://www.logitech.com/options)

- 1 下載 Logitech Options，按一下「新增裝置」，然後選擇「新增 Unifying 裝置」

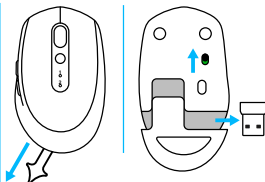

- 2 取下所有拉條或確認滑鼠已開啓電源，然後從電池槽中取出 Unifying 接收器

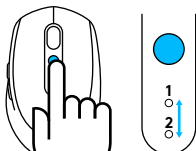

1 秒

- 3 短按 Easy-Switch 按鈕可選擇想要的頻道

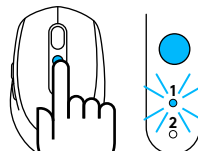

3 秒

- 4 長按 Easy-Switch 按鈕可進入配對模式

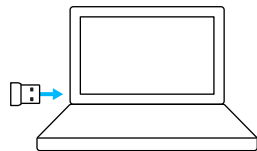

- 5 插入 Unifying USB 接收器

### 修復現有的 Unifying 接收器

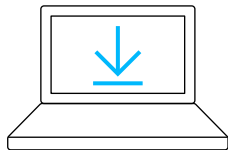

[www.logitech.com/unifying](http://www.logitech.com/unifying)

- 1 下載 Logitech Unifying 軟體

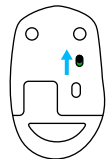

- 2 確認滑鼠電源已開啓

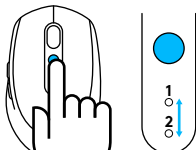

1 秒

- 3 短按 Easy-Switch 按鈕可選擇想要的頻道

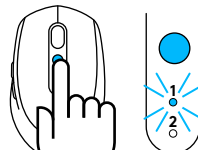

3 秒

- 4 長按 Easy-Switch 按鈕可進入配對模式

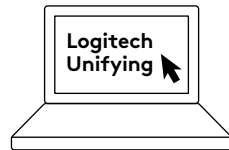

- 5 開啓 Unifying 軟體，然後依照螢幕上的指示進行

## 連線到 2 個系統

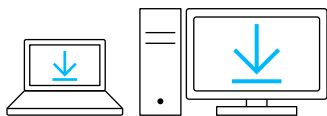

[www.logitech.com/options](http://www.logitech.com/options)

- 1 在兩個系統上都下載 Logitech Options

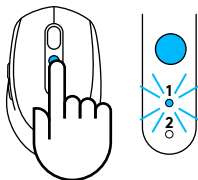

3 秒

- 2 確認滑鼠電源已開啓

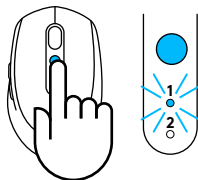

3 秒

- 3 長按 Easy-Switch 按鈕可進入配對模式



- 4 透過 Unifying USB 接收器或藍牙連線到您的第一台電腦

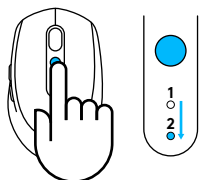

1 秒

- 5 短按 Easy-Switch 按鈕可切換到下一個頻道

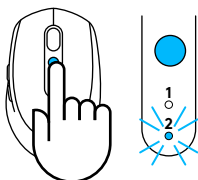

3 秒

- 6 長按 Easy-Switch 按鈕可進入配對模式



- 7 透過 Unifying USB 接收器或藍牙連線到您的第二台電腦

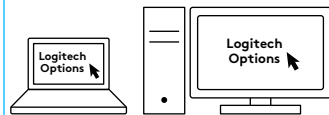

ENABLE FLOW

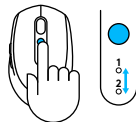

- 8 透過 Logitech Options 啟用 FLOW，或按下 Easy-Switch 按鈕在裝置間切換

羅技 M585/590 Silent 滑鼠可以使用藍牙或羅技 Unifying 接收器，連線到最多兩台電腦。包裝盒內隨附一個接收器。

# 시스템 요구 사항

## Unifying USB 수신기

사용 가능한 USB 포트

Windows® 10 이상

Windows® 8 이상

Windows® 7 이상

MAC OS X 10.10

Chrome OS™

Linux Kernel 2.6

## Bluetooth® LE

Windows® 10 이상

Windows® 8 이상

MAC OS X 10.10

Chrome OS™

Android 5.0 이상

## Logitech Options

Windows® 10,

Windows 8 및

Windows 7

MAC OS X 10.10 이상

로지텍 Flow 기능을 사용하려면 호환 마우스와 동일한 네트워크에 연결된 두 대 이상의 컴퓨터가 필요합니다.

# 제품 설명

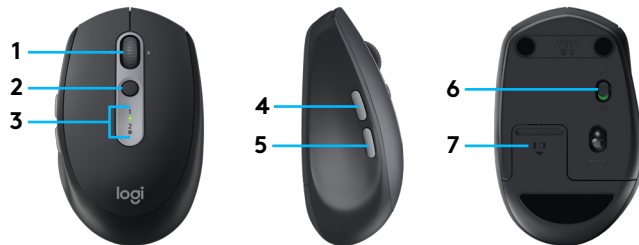

1 스크롤 휠 버튼 및 틸트 버튼

2 Easy-Switch™ 버튼

3 이지스위치 채널 및 배터리 표시기

4 앞으로 가기 버튼

5 뒤로 가기 버튼

6 전원 On/Off 스위치

7 배터리 및 Unifying 수신기 보관 슬롯\*

\* Unifying 수신기는 안에 들어있음

# 연결

## Bluetooth 무선 기술

USB 슬롯이 부족한 경우, Bluetooth를 이용하여 M585 또는 M590 Silent 마우스를 컴퓨터에 연결할 수 있습니다. 호환성 요구 사항은 시스템 요구 사항을 참조하십시오.

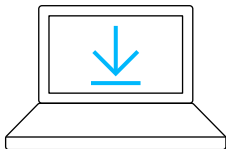

[www.logitech.com/options](http://www.logitech.com/options)

- 1 Logitech Options를 다운로드하고 '장치 추가'를 클릭한 다음 'Bluetooth 장치 추가'를 선택하십시오.

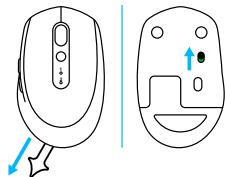

- 2 배터리 쉘을 제거하거나 마우스가 켜져 있는지 확인하십시오.

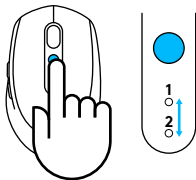

- 3 Easy-Switch 버튼을 짧게 눌러 원하는 채널을 선택하십시오.

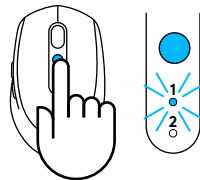

- 4 Easy-Switch 버튼을 길게 눌러 페어링 모드로 들어가십시오.

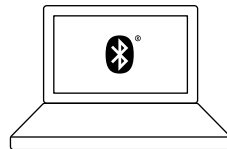

- 5 Bluetooth 장치 목록에서 M585/M90 마우스를 찾아 연결하십시오.

로지텍 M585/M590 Silent는 Bluetooth를 통해 컴퓨터와 하나의 이지스위칭 채널에 연결할 수 있습니다.



## Unifying USB 수신기

하나의 초소형 수신기로 최대 6개의 Unifying 장치를 연결할 수 있습니다. 연결하기만 하면 한 대의 컴퓨터에 마우스 및 키보드를 추가로 연결할 수 있습니다.

### 처음 연결할 때

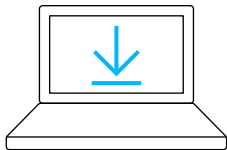

[www.logitech.com/options](http://www.logitech.com/options)

- 1 Logitech Options를 다운로드하고 '장치 추가'를 클릭한 다음 'Unifying 장치 추가'를 선택하십시오.

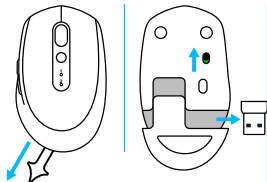

- 2 배터리 쉘을 제거하거나 마우스가 켜져 있는지 확인하고 배터리 커버에서 Unifying 수신기를 뽑습니다.

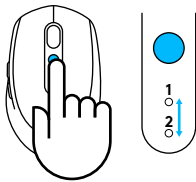

1초

- 3 Easy-Switch 버튼을 짧게 눌러 원하는 채널을 선택하십시오.

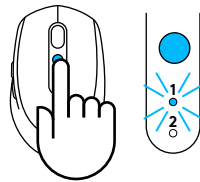

3초

- 4 Easy-Switch 버튼을 길게 눌러 페어링 모드로 들어가십시오.

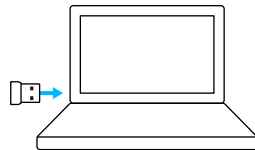

- 5 Unifying USB 수신기 삽입

## 사용중이던 Unifying 수신기에 연결할 때

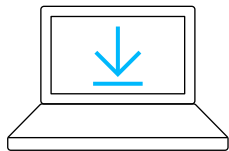

[www.logitech.com/unifying](http://www.logitech.com/unifying)

- 1 Logitech Unifying 소프트웨어를 다운로드합니다.

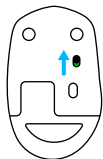

- 2 마우스가 켜져 있는지 확인합니다.

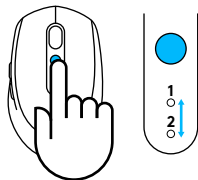

1초

- 3 Easy-Switch 버튼을 짧게 눌러 원하는 채널을 선택하십시오.

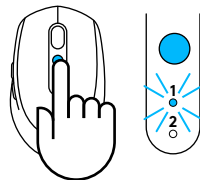

3초

- 4 Easy-Switch 버튼을 길게 눌러 페어링 모드로 들어가십시오.

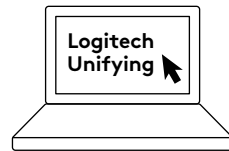

- 5 Unifying 소프트웨어를 열고 화면 지침을 따릅니다.

## 두 대의 시스템에 연결

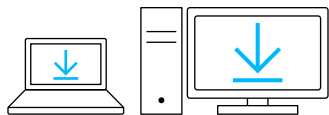

[www.logitech.com/options](http://www.logitech.com/options)

- 1 두 시스템 모두에서 Logitech Options를 다운로드합니다.

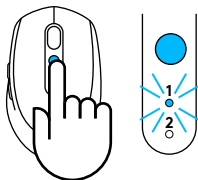

3초

- 2 마우스가 켜져 있는지 확인합니다.

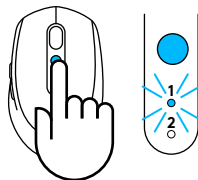

3초

- 3 Easy-Switch 버튼을 길게 눌러 페어링 모드로 들어가십시오.



- 4 Unifying USB 수신기 또는 Bluetooth를 통해 첫 번째 컴퓨터에 연결합니다.

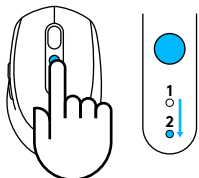

1초

- 5 Easy-Switch 버튼을 짧게 눌러 다음 채널로 전환하십시오.

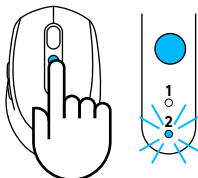

3초

- 6 Easy-Switch 버튼을 길게 눌러 페어링 모드로 들어가십시오.



- 7 Unifying USB 수신기 또는 Bluetooth를 통해 두 번째 컴퓨터에 연결합니다.

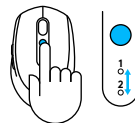
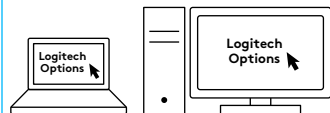

- 8 Logitech Options를 통해 FLOW를 활성화하거나 Easy-Switch 버튼을 눌러 기기 사이를 전환합니다.

로지텍 M585/590 Silent는 Bluetooth 또는 Logitech Unifying 수신기를 이용해 최대 두 대의 컴퓨터에 연결할 수 있습니다. 상자에 Unifying 수신기 하나가 동봉되어 있습니다.

© 2017 Logitech. Logitech, Logi, 罗技 and other Logitech marks are owned by Logitech and may be registered. All other trademarks are the property of their respective owners.

版权所有 © 2017 年罗技。罗技、Logi 和其他罗技商标均归罗技所有，并或已注册。所有其他商标均是其各自所有者的财产。

版權所有 © 2017 年羅技。羅技、Logi 和其他羅技商標均歸羅技所有，並或已註冊。所有其他商標均是其各自所有人的財產。

© 2017 Logitech. Logitech, Logi 및 기타 Logitech 상표는 Logitech의 소유이며 등록 상표일 수 있습니다. 그 밖의 모든 상표는 해당 소유자의 자산입니다.

WEB-621-000860.002